

The City of Cambridge, with Stoss Landscape Urbanism, is constructing two new parks in eastern Cambridge: Binney Street Park and Triangle Park. Construction for these parks is expected to begin in Spring 2018.

The park designs and refinements have been guided by the Eastern Cambridge/Kendall Open Space Study and Connect Kendall Square Open Space Competition and Framework Plan and shaped by input from the community.



**For more information:**

[cambridgema.gov/kendallopenspace](http://cambridgema.gov/kendallopenspace)

**Contact:**

Gary Chan  
Community Development Department  
gchan@cambridgema.gov  
617/349-4603



**STOSS**

**BINNEY STREET PARK  
TRIANGLE PARK**





# TRIANGLE PARK

Triangle Park will feature a hardscape **OPEN PLAZA** framed by a grove of trees and **PLANTED LANDFORM**. A sloped lawn faces the plaza, providing additional space for small community events.

Within the plaza is a **SEATING GROVE** and custom wooden **AMPHITHEATER SEATING** that provides a range of seating options for passive enjoyment of the new park. An **ELEVATED WALKWAY** rises out of lawn and forms an overlook with a view to and across the Charles River.

In the tree canopy, the fall zenith will offer a gradation of color moving from north to south with the bright red of Sweet Gum and Pin Oak to the yellow of Quaking Aspen. The planting palette was selected to provide both shade in the summer months and greenery through the winter months.

**STORMWATER GARDENS** capture rainwater as a part of the park's approach to passive stormwater management, and a temporal **WATER PLAZA** make visible the relationship between built and natural systems that come together in the park space.

Triangle Park, located between First Street, Edwin H. Land Boulevard, and Binney Street, is a new open plaza space that is a stepping stone to the Charles River.



# TRIANGLE - SITE PROGRAM



# TRIANGLE - SITE MATERIAL

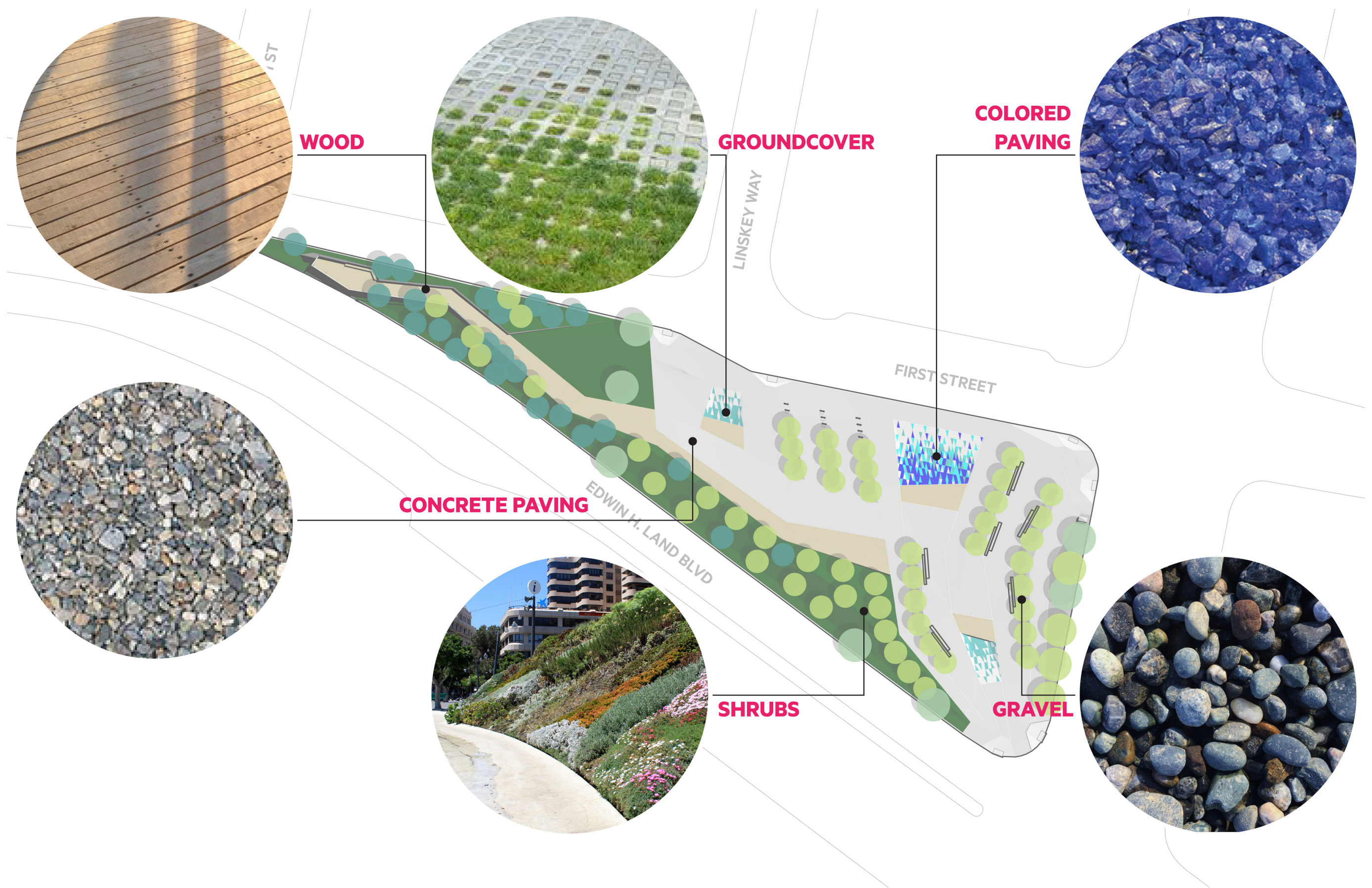

# TRIANGLE - SITE PLANTING

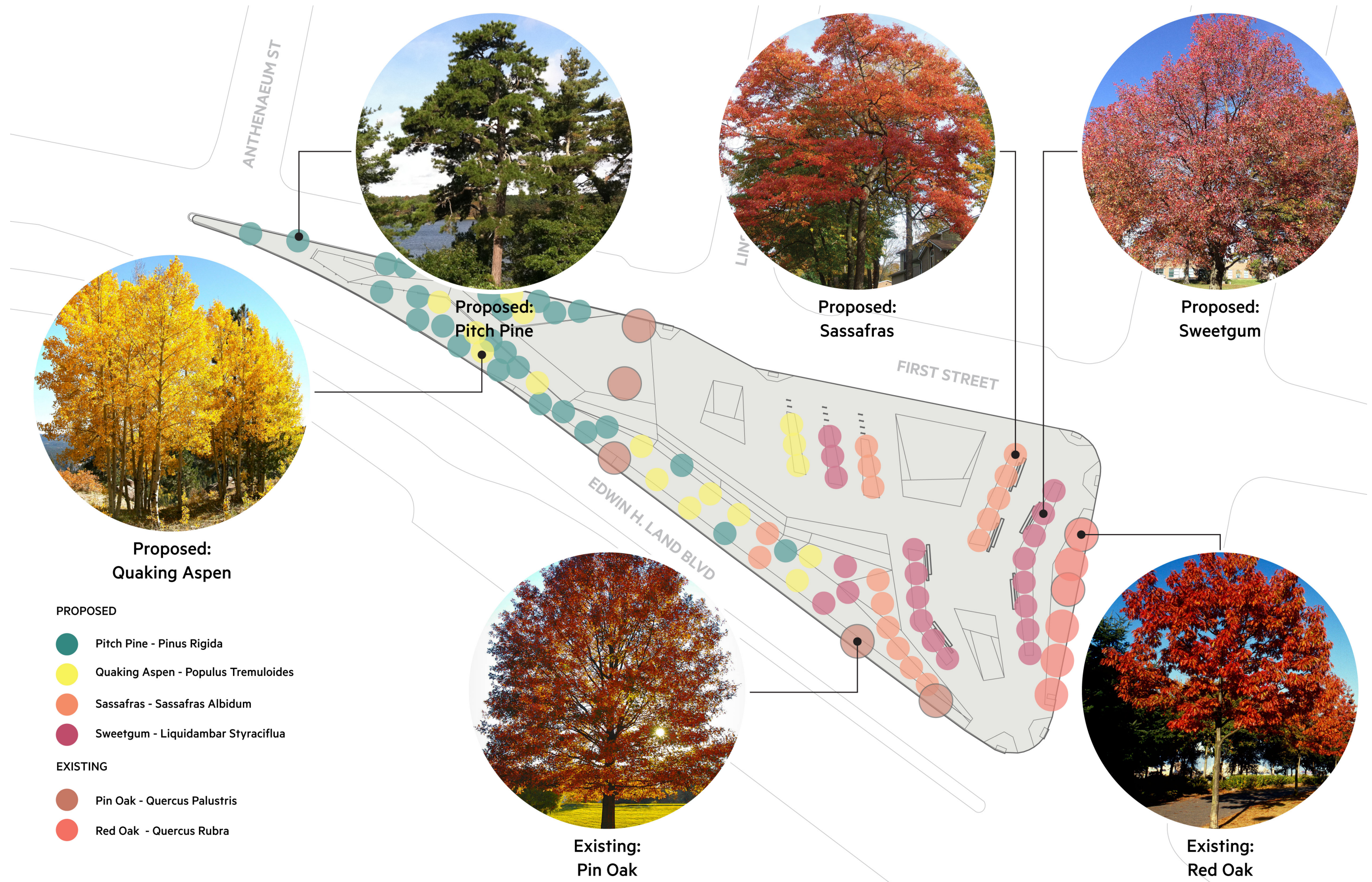

# BINNEY STREET PARK

Binney Street Park, located between Binney Street and Broadway along Galileo Galilei Way, provides a new open space resource at the nexus of multiple Cambridge neighborhoods.

The new Binney Street Park features a fenced off-leash **DOG RUN** that combines ample space for running with **LOUNGE & PLAY SURFACES** to climb and shaded seating for dog owners under a cluster of existing shade trees. The dog run will include a dog-friendly water fountain and three entrances, each with a double-gated entry system for safe entry and exit from the off-leash area.

The new park will include a segment of the planned **GRAND JUNCTION GREENWAY**, which will provide a future off-road pedestrian and

bicycle connection to the park. Adjoining the Greenway is a **PLAZA** shaped by custom-designed sculptural wooden seating that continues along the park's interior path. Straddling the path and the dog run is **LOG SEATING** that doubles as a **DOG PLAY** area inside the fence, and informal seating and play outside.

**PLANTED SLOPES** and proposed new trees complement existing trees at the park site to provide a soft edge to the park and shade for park visitors.



# BINNEY - SITE PROGRAM





# BINNEY - SITE MATERIAL

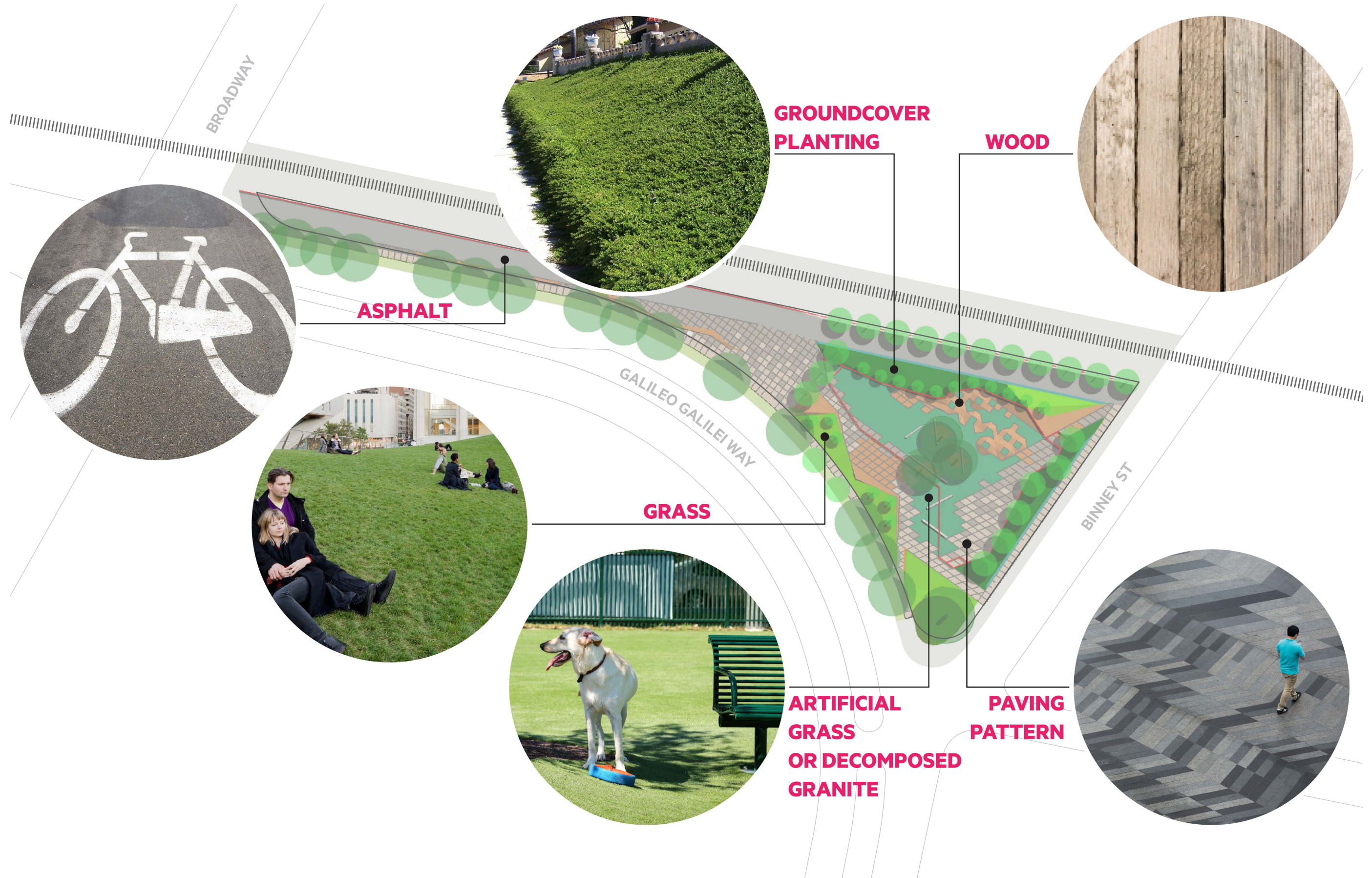

# BINNEY - SITE PLANTING

