

City of Cambridge
Community Development Department

Bicycle Committee Meeting

October 14, 2020

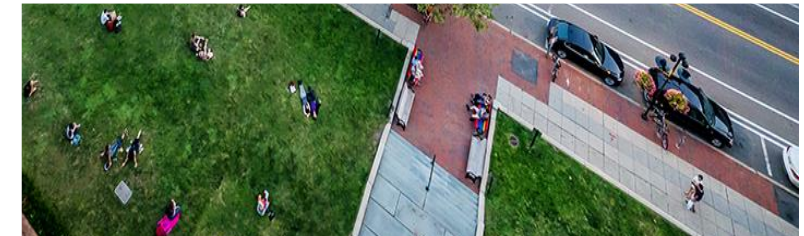

Meeting Agenda

1. Zoom meeting protocols, minutes
2. Upcoming Bicycle Pavement Marking Proposals
 1. Banks Street
 2. Hampshire/Broadway
3. Project Updates
 1. TP&T
 2. DPW
 3. Tobin and Vassal Lane Schools
4. Public Comment
5. Development Projects
 1. 325 Binney Street
6. Public Comment
7. Bicycle Committee Work
8. Other Updates and Announcements



Committee Member Instructions

- Committee members may speak and show webcam video
 - Use "Raise Hand" button to help manage discussion
 - *9 to Raise Hand by phone
- Please stay muted unless speaking
 - *6 to mute/unmute by phone

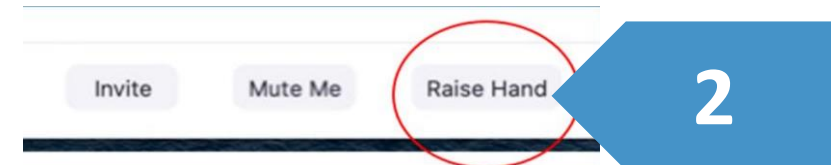
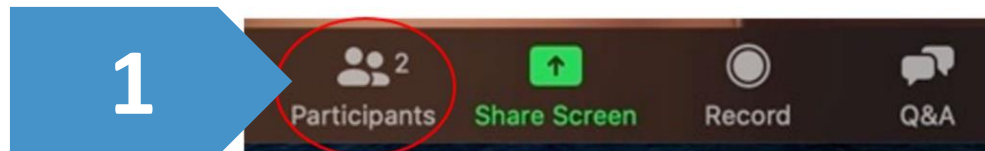

Public Comment Instructions

- Members of the public are muted and cannot show webcam video
- Public can write questions or ask for assistance in Q&A window at any time
 - Questions may be submitted at any time and will be addressed as time allows, during discussion/comment periods
- During the Public Comment period, use the "Raise Hand" button to signal you have a question/comment. A staff member will then enable you to unmute yourself.
 - *9 to Raise Hand by phone
 - *6 to Mute/Unmute by phone
- Please be respectful! Participants will be removed for inappropriate behavior

Bottom Panel of
Zoom Screen

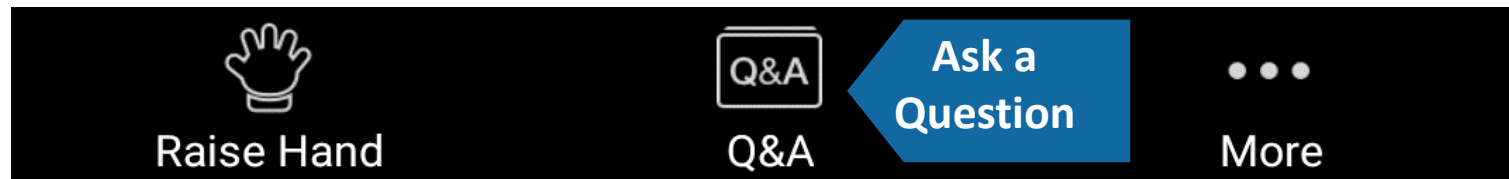



Minutes



Bicycle Pavement Marking Proposals

Stephen Meuse, *Traffic, Parking, and Transportation Dept*

Banks Street

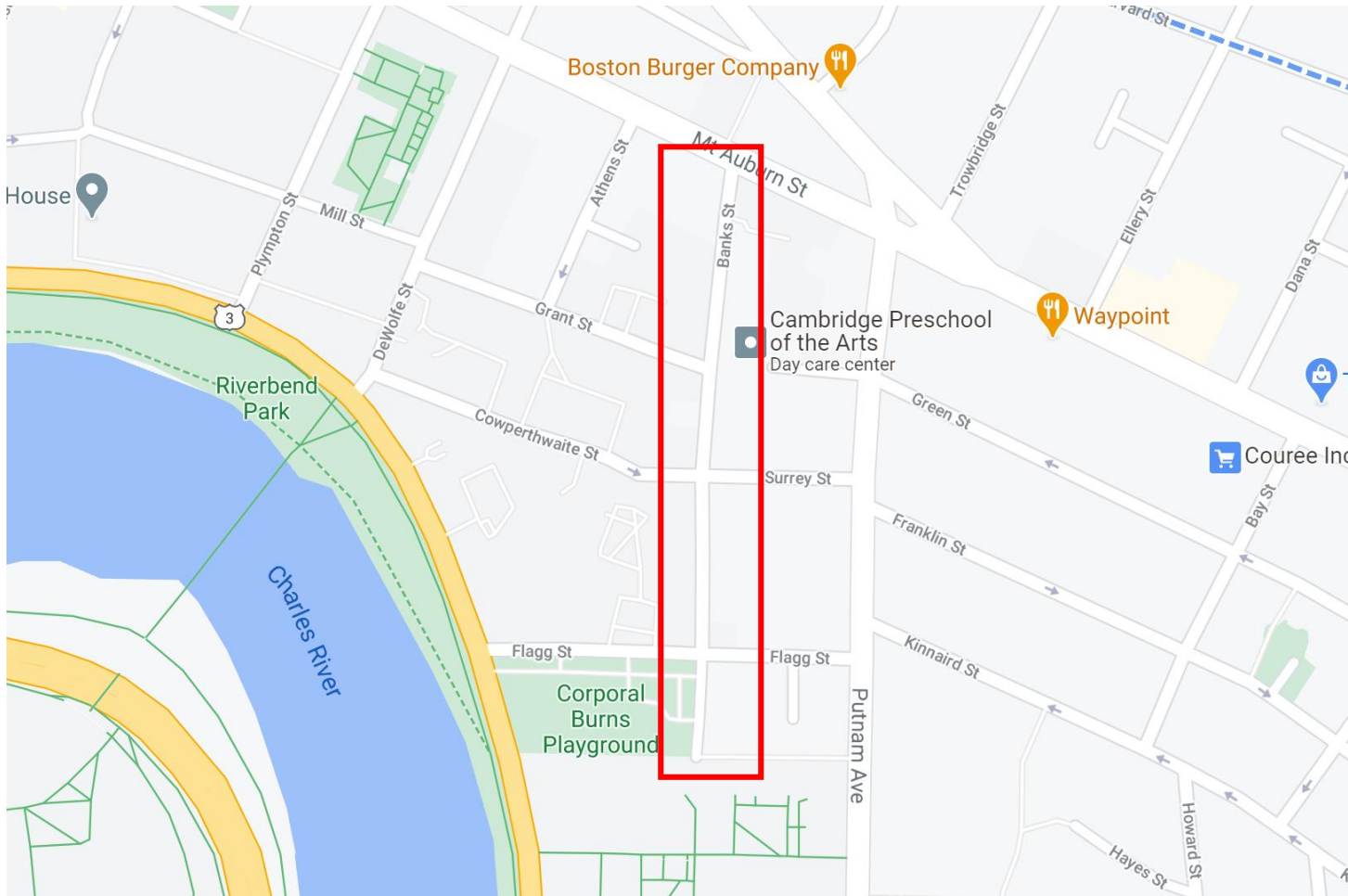

North of Surrey St/Cowperthwaite St

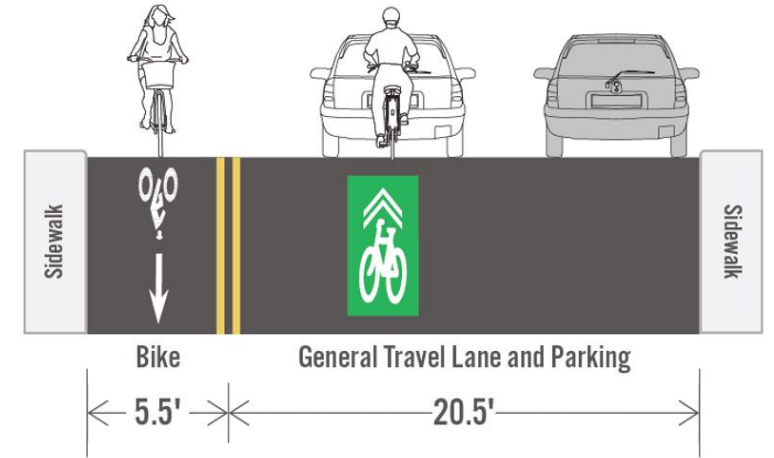

South of Surrey St/Cowperthwaite St

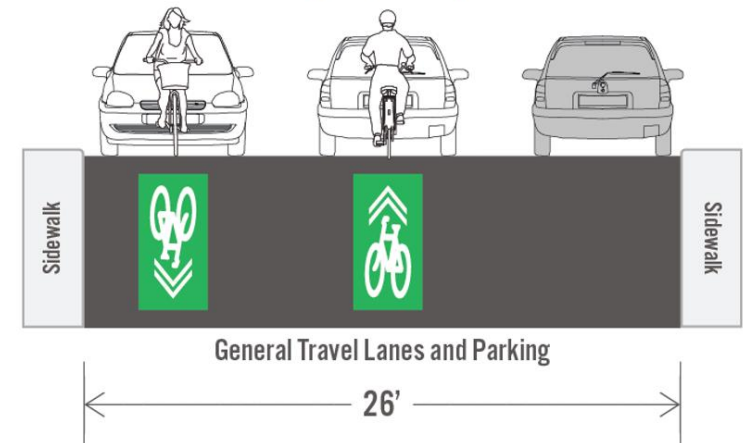

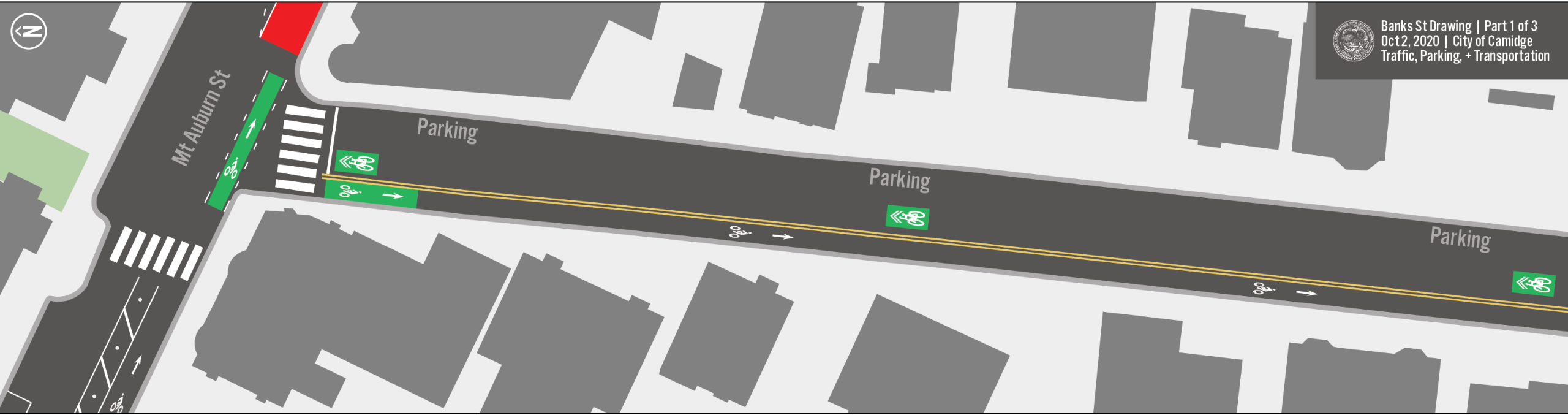

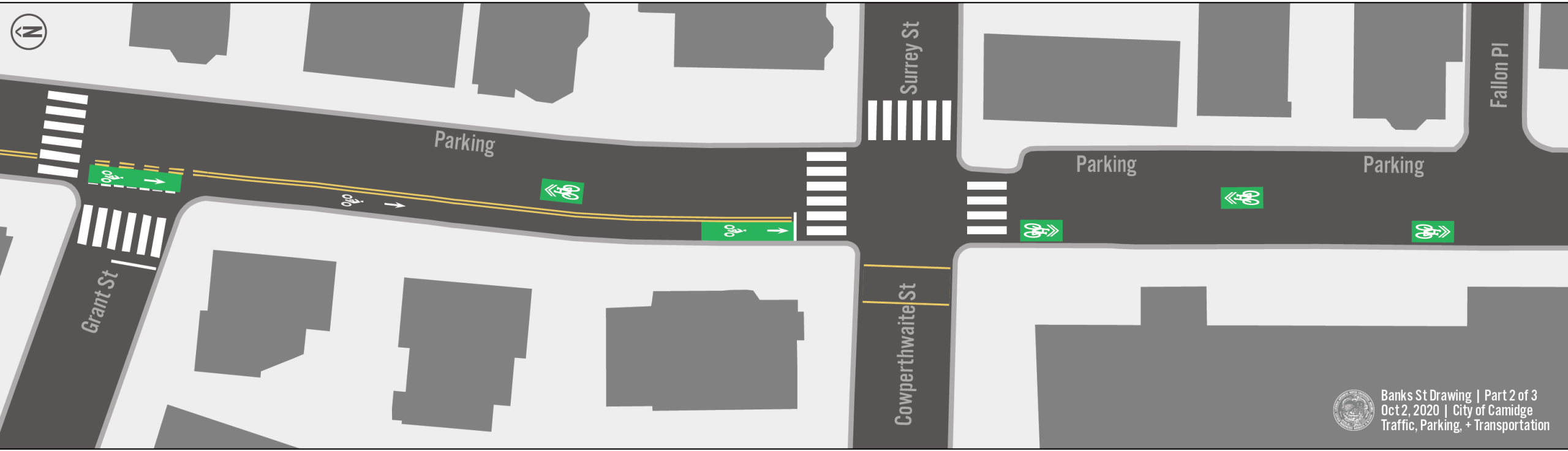

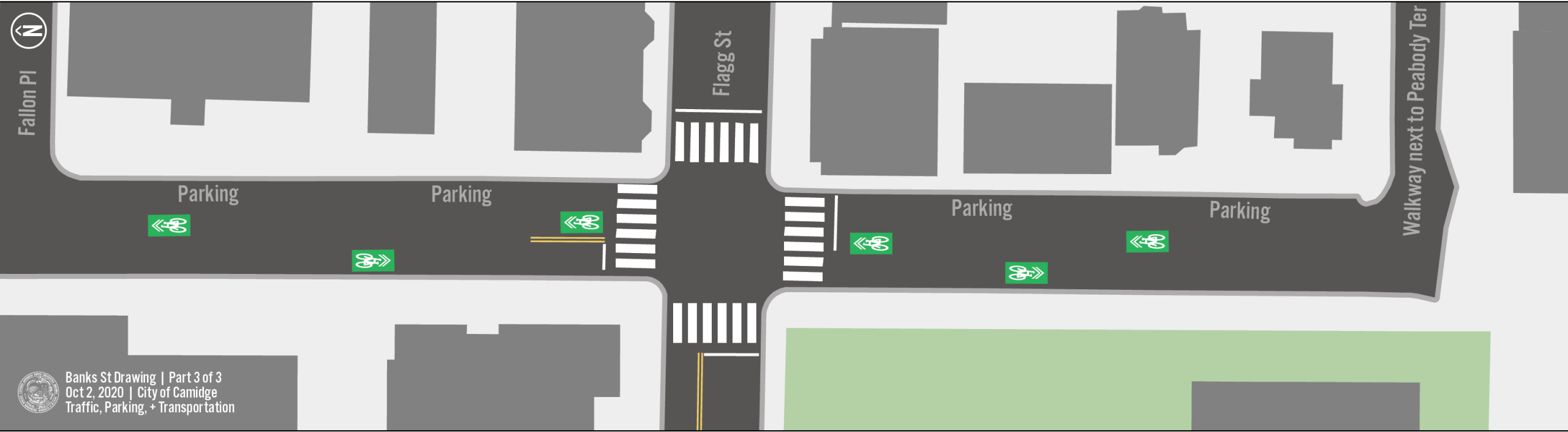

Fallon Pl

Flagg St

Walkway next to Peabody Ter



Banks St Drawing | Part 3 of 3
Oct 2, 2020 | City of Cambridge
Traffic, Parking, + Transportation

Hampshire/Broadway





TP&T Updates



DPW Updates



Tobin and Vassal Lane Schools

AREA IMPROVEMENTS

STUDENT DROP OFF AND PICK UP

- 1 Bike and bike share parking
- 2 Below grade parking
- 3 Parent drop-off/pick-up separated from busses
- 4 Eliminate on-street drop-off



AREA IMPROVEMENTS

PARENT DROP-OFF AND PICK-UP BY CAR

1 Sub-grade parking
across from Standish

2 Student drop-off

Student Drop-off/
Pick-up Travel Pattern



AREA IMPROVEMENTS

SITE PLANNING AND BUS LOOP

- 1 Pedestrian path with emergency/service access
- 2 Loading zone
- 3 Community Path
- 4 Pedestrian signals
- 5 Bus loop



AREA IMPROVEMENTS



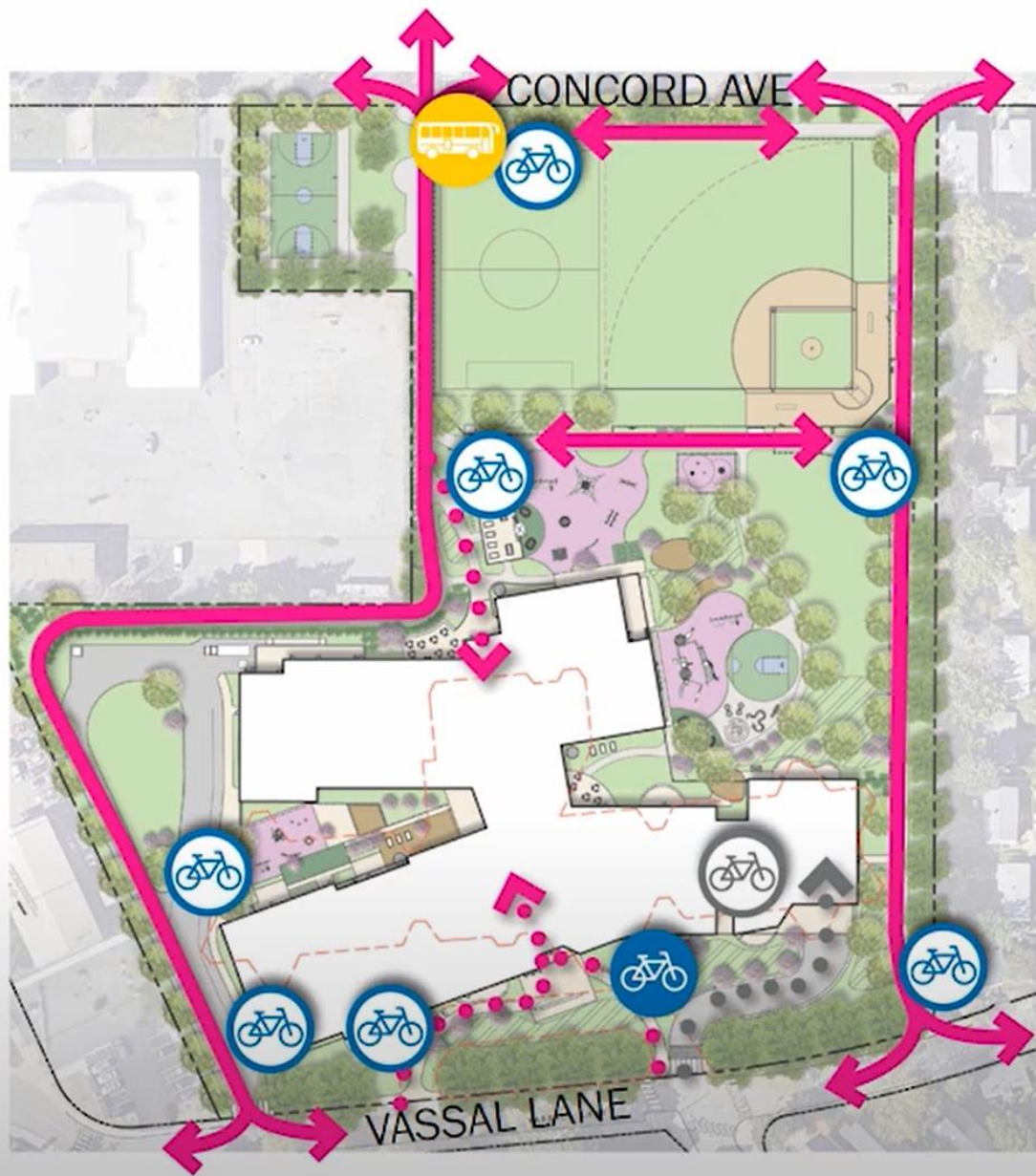

VASSAL LANE IMPROVEMENTS

- 1 School zone flashers
- 2 Sidewalk and pedestrian improvements
- 3 Traffic calming measures
- 4 Safety measures at Standish intersection





LEGEND

-  MAIN ROUTE TO BUILDING
-  MULTI-USE PATHS
-  BIKE ACCESS TO UNDERGROUND
-  BIKE RACKS
-  BLUE BIKE DOCKING
-  UNDERGROUND BIKE STORAGE
-  BUS STOP



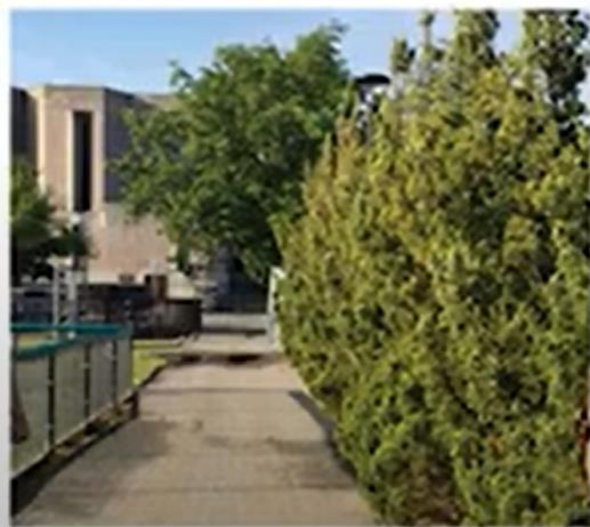

1



PROPOSED VIEW

TRAVERSE



2

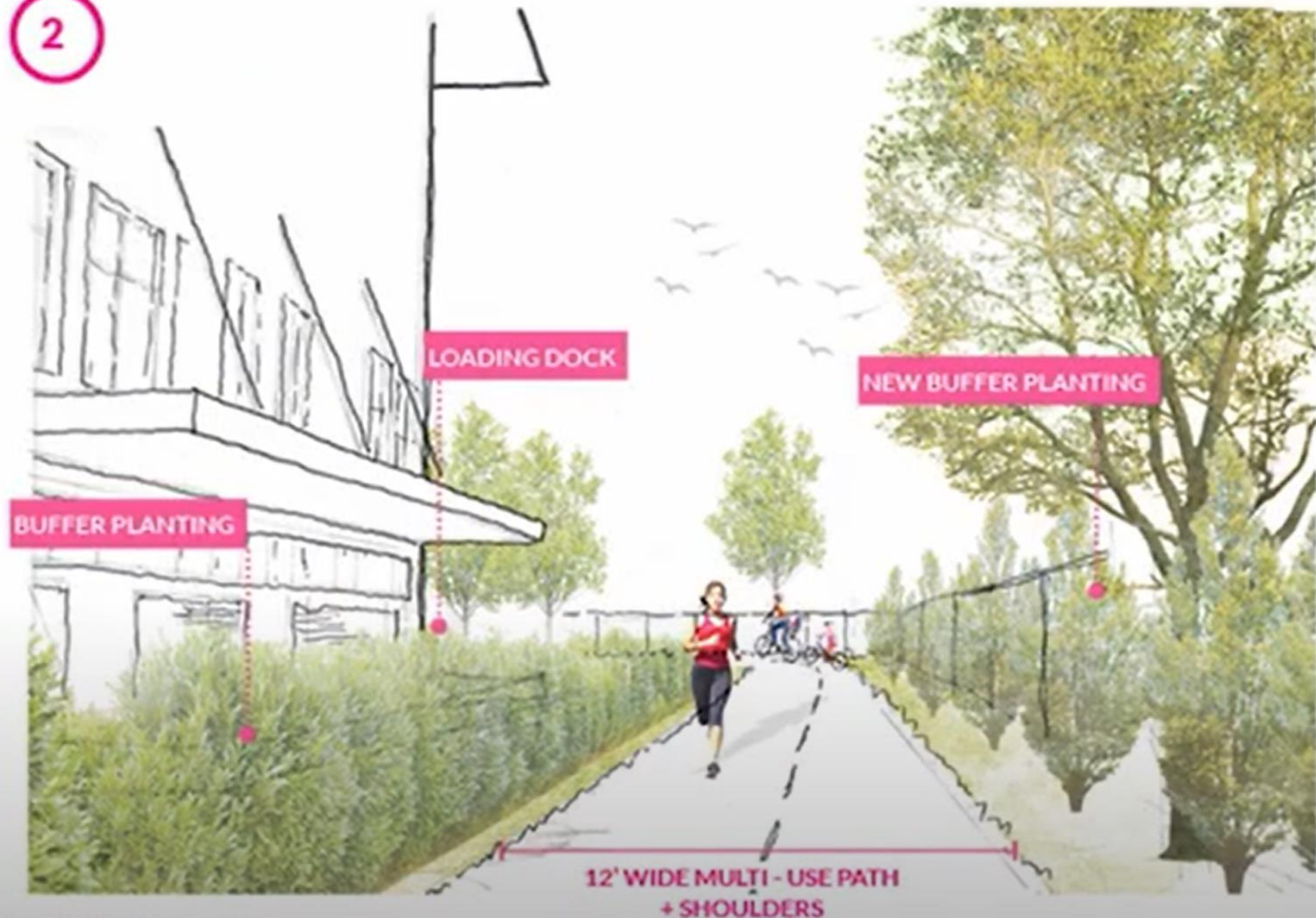

PROPOSED VIEW

TRAVERSE



3



PROPOSED VIEW

TRAVERSE



4

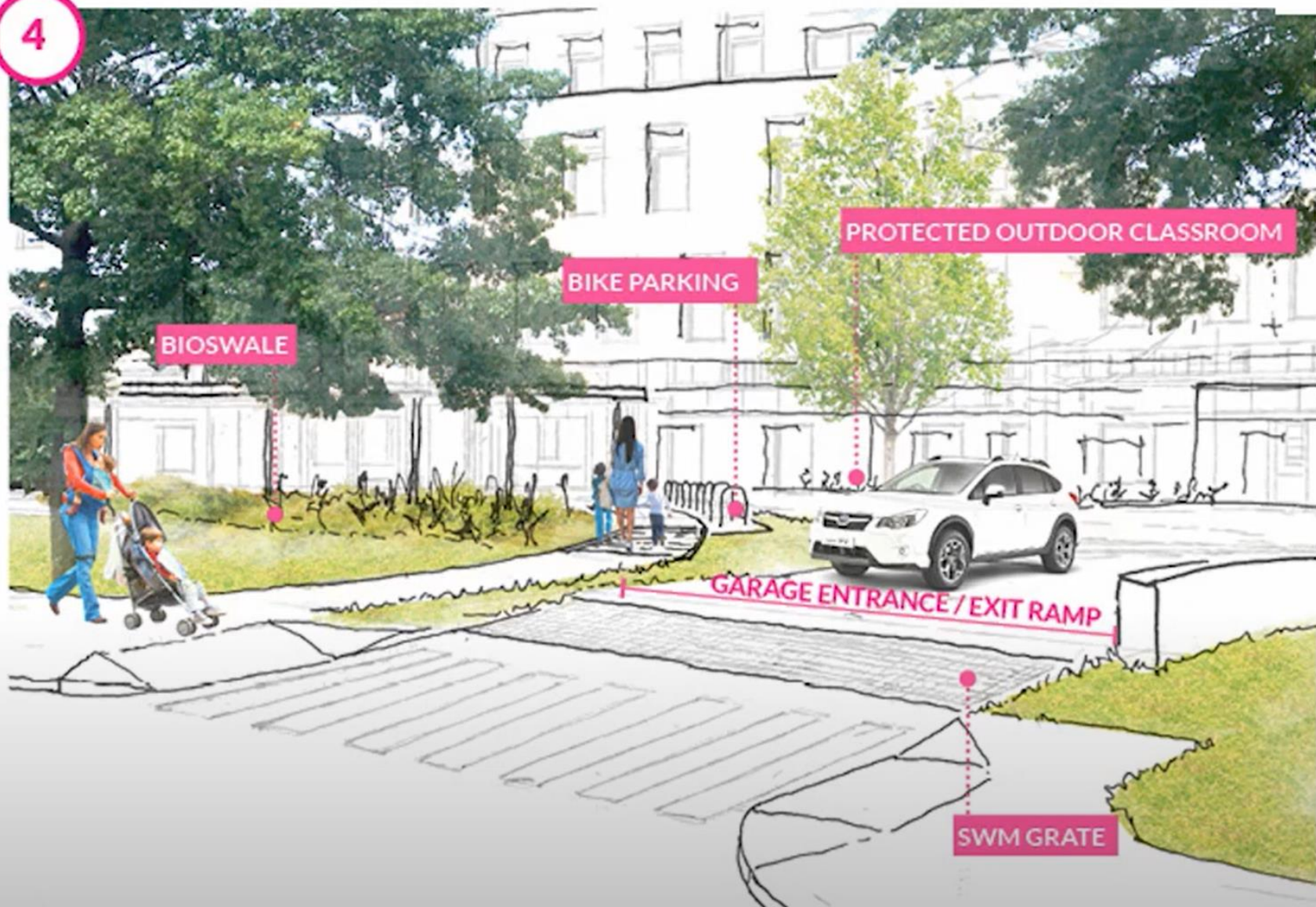

PROPOSED VIEW

TRAVERSE



5



PROPOSED VIEW

TRAVERSE



6

POSSIBLE PV PANEL LOCATION

MULTI-USE FIELD

PLAY SPACE

8' WIDE PATH

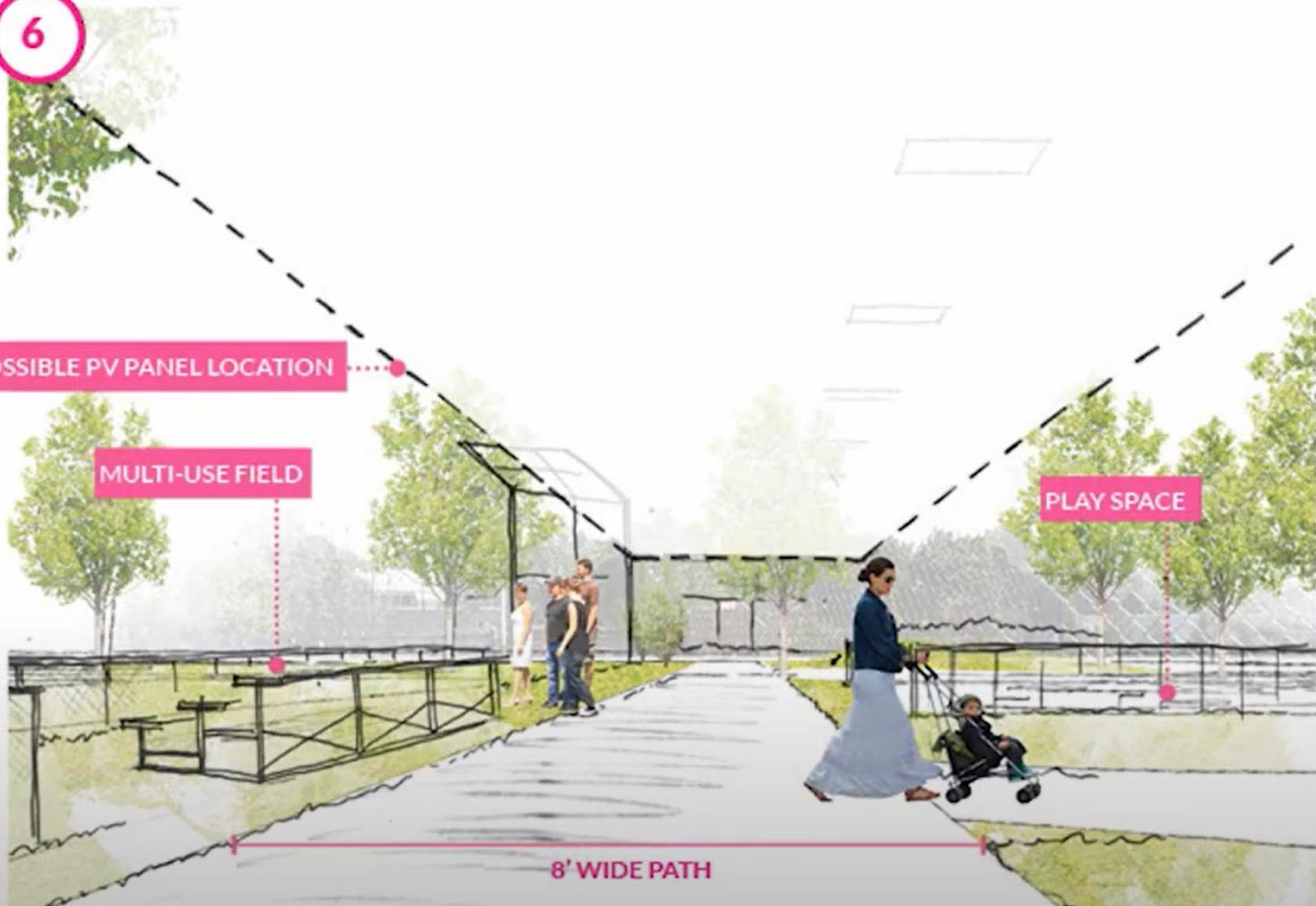

PROPOSED VIEW

TRAVERSE



7

CONCORD AVE
STREET AND
SIDEWALK

VEGETATIVE BUFFER

MULTI-USE FIELD

10' WIDE PATH

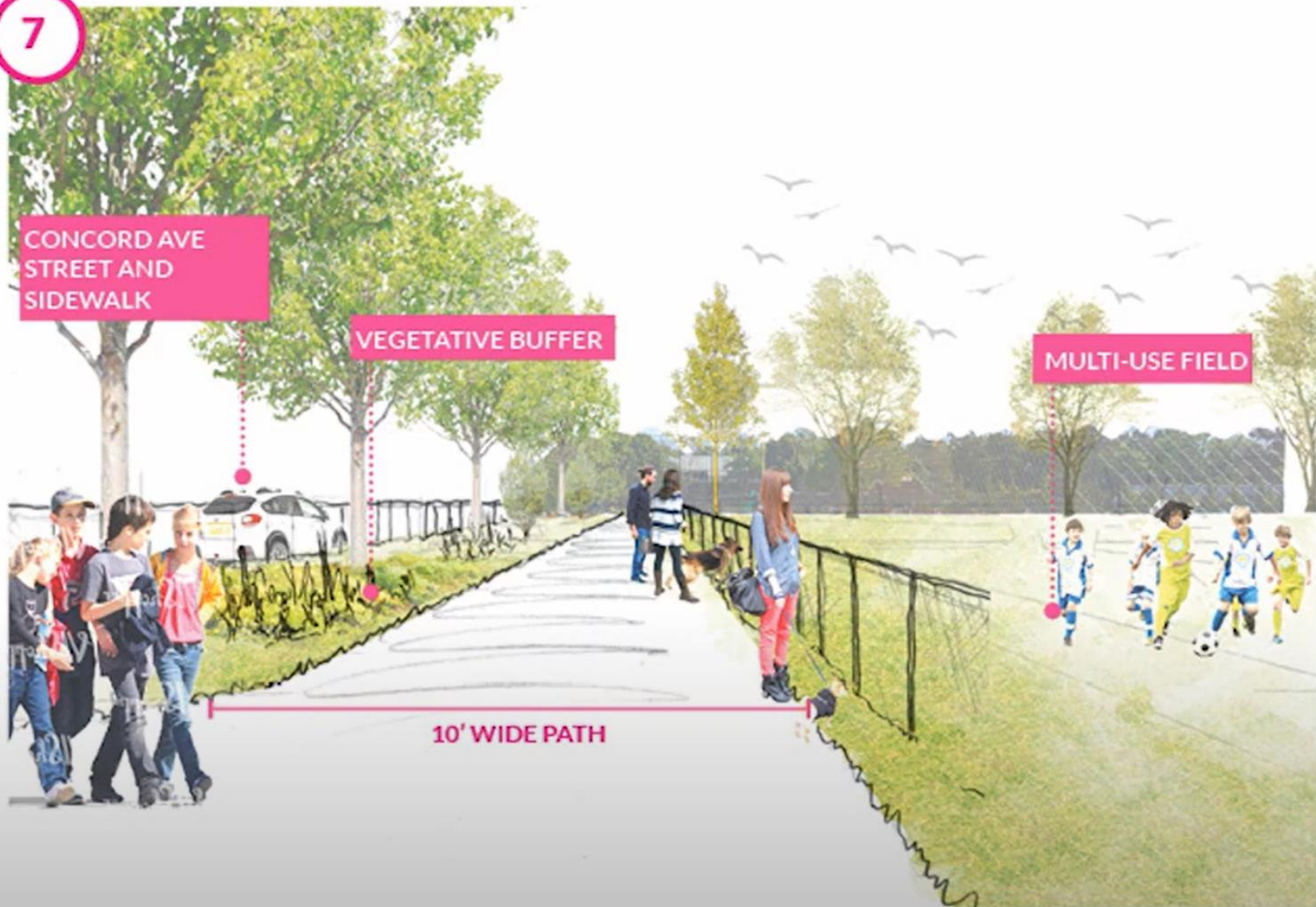

PROPOSED VIEW

TRAVERSE

CURRENT DESIGN SCHEDULE

PROJECT PHASES





Other projects

Major Roadway Projects Underway

July 2020

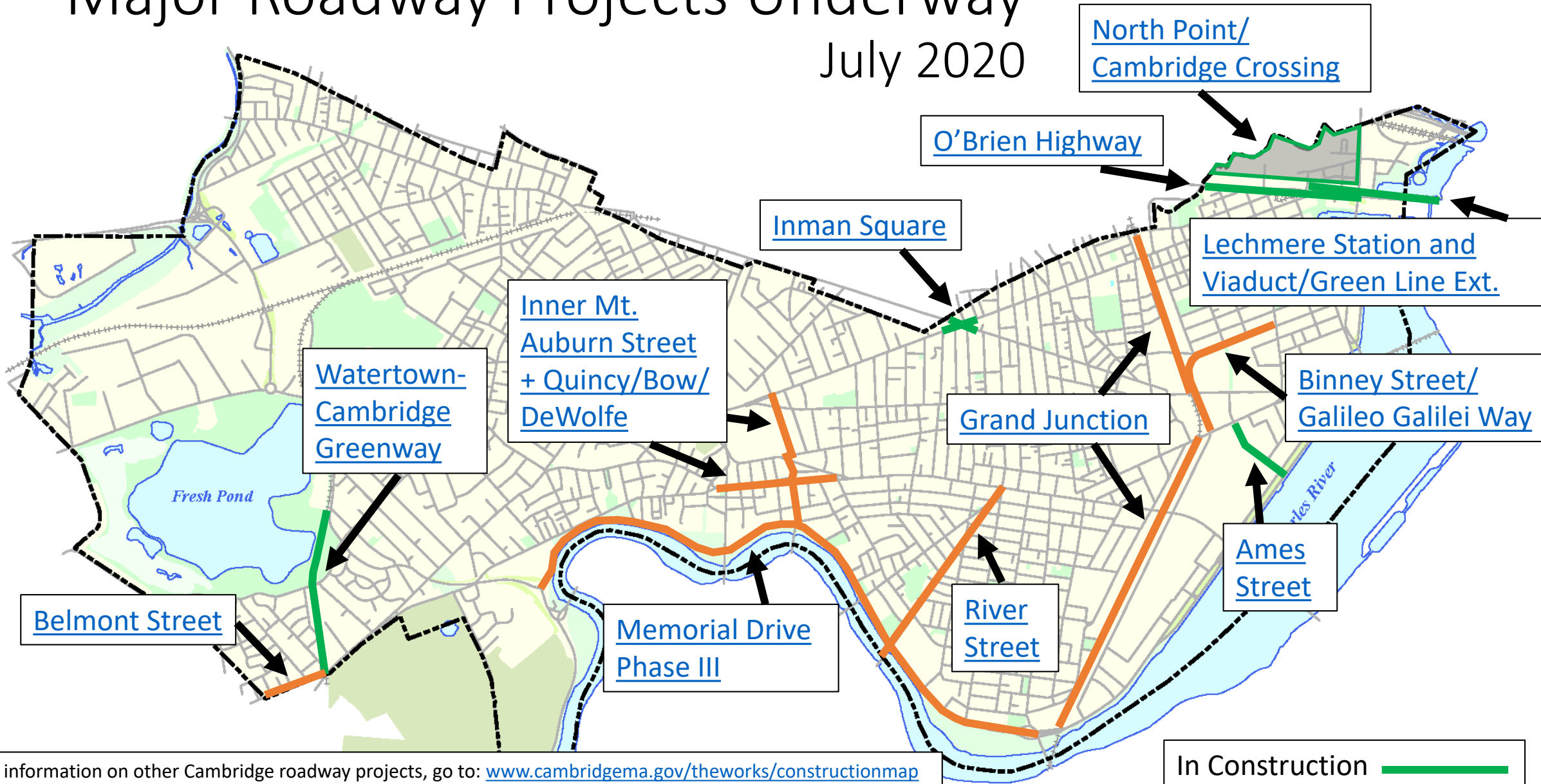

For information on other Cambridge roadway projects, go to: www.cambridgema.gov/theworks/constructionmap
To see recently completed bicycle facility improvements projects, go to: www.cambridgema.gov/bikeprojects

In Construction 
Under Design 



Public comment

Public Comment Instructions

- Use the "Raise Hand" button to signal you have a question/comment. A staff member will then enable you to unmute yourself.
 - *9 to Raise Hand by phone
 - *6 to Mute/Unmute by phone
- Questions can also be submitted using the Q&A button.

Bottom Panel of
Zoom Screen

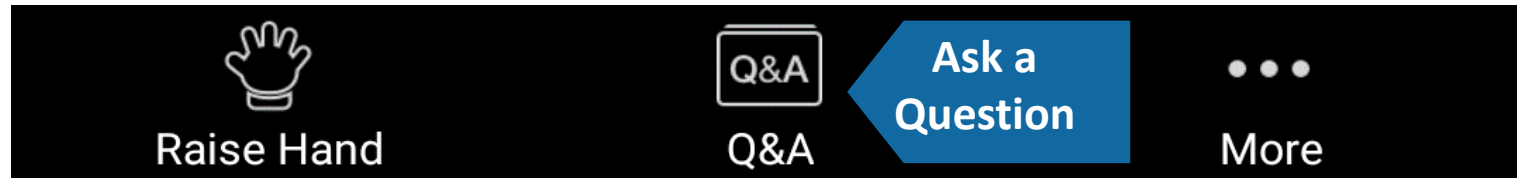



325 Binney St Development Project

Site Context Plan

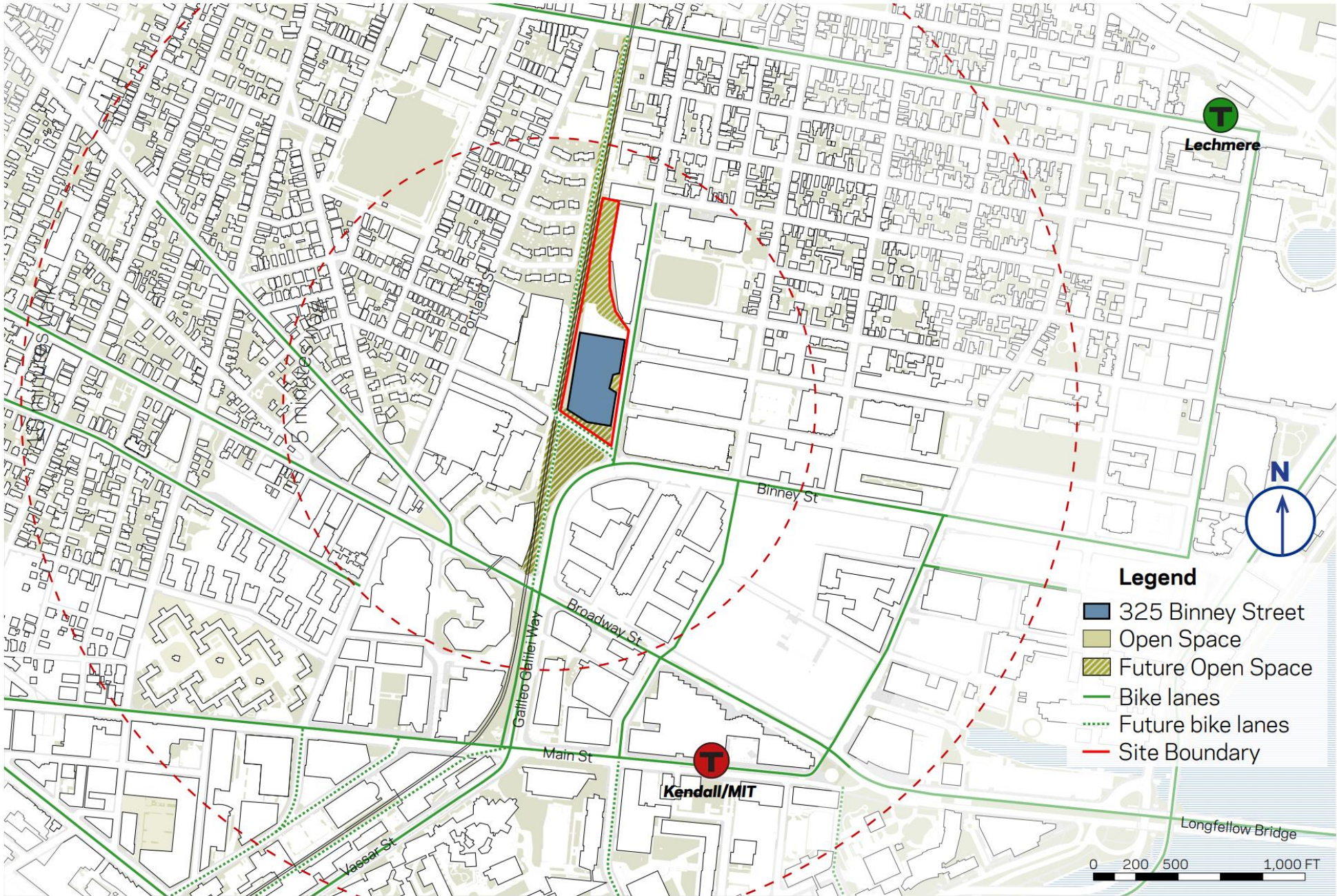

Grand Junction Multi-Use Path

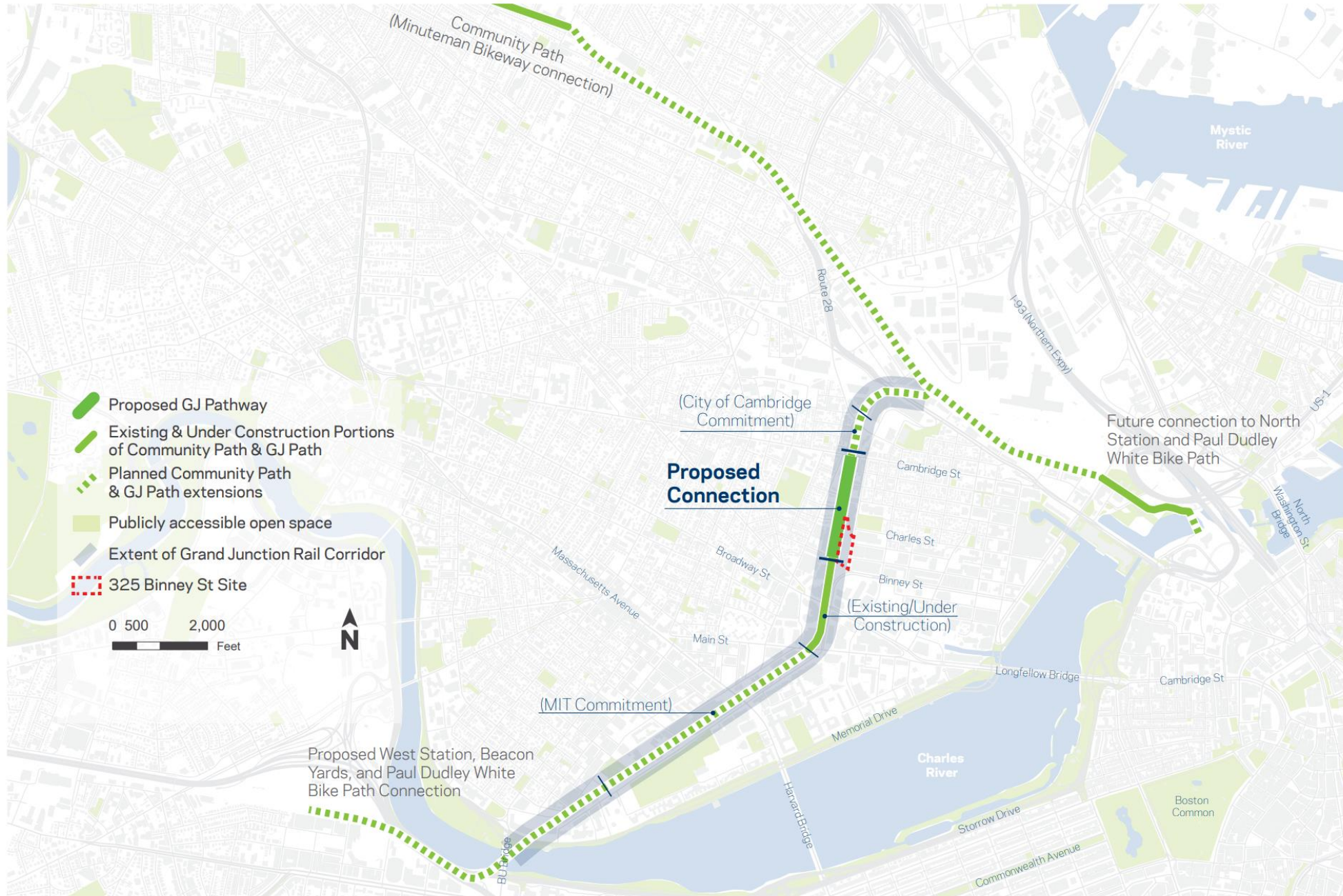

Aerial View Looking West

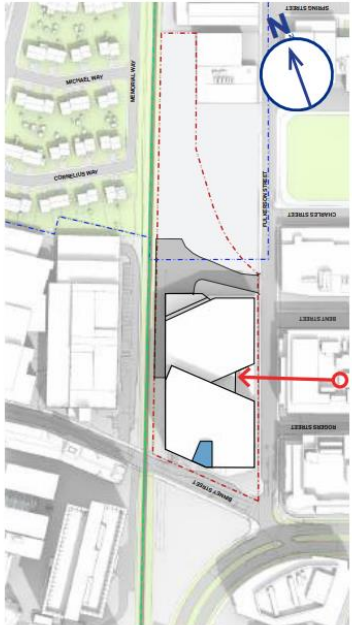

Aerial View from South Binney Street Corner





ALEXANDRIA



Landscape Plan

From Special Permit Application, August 2020



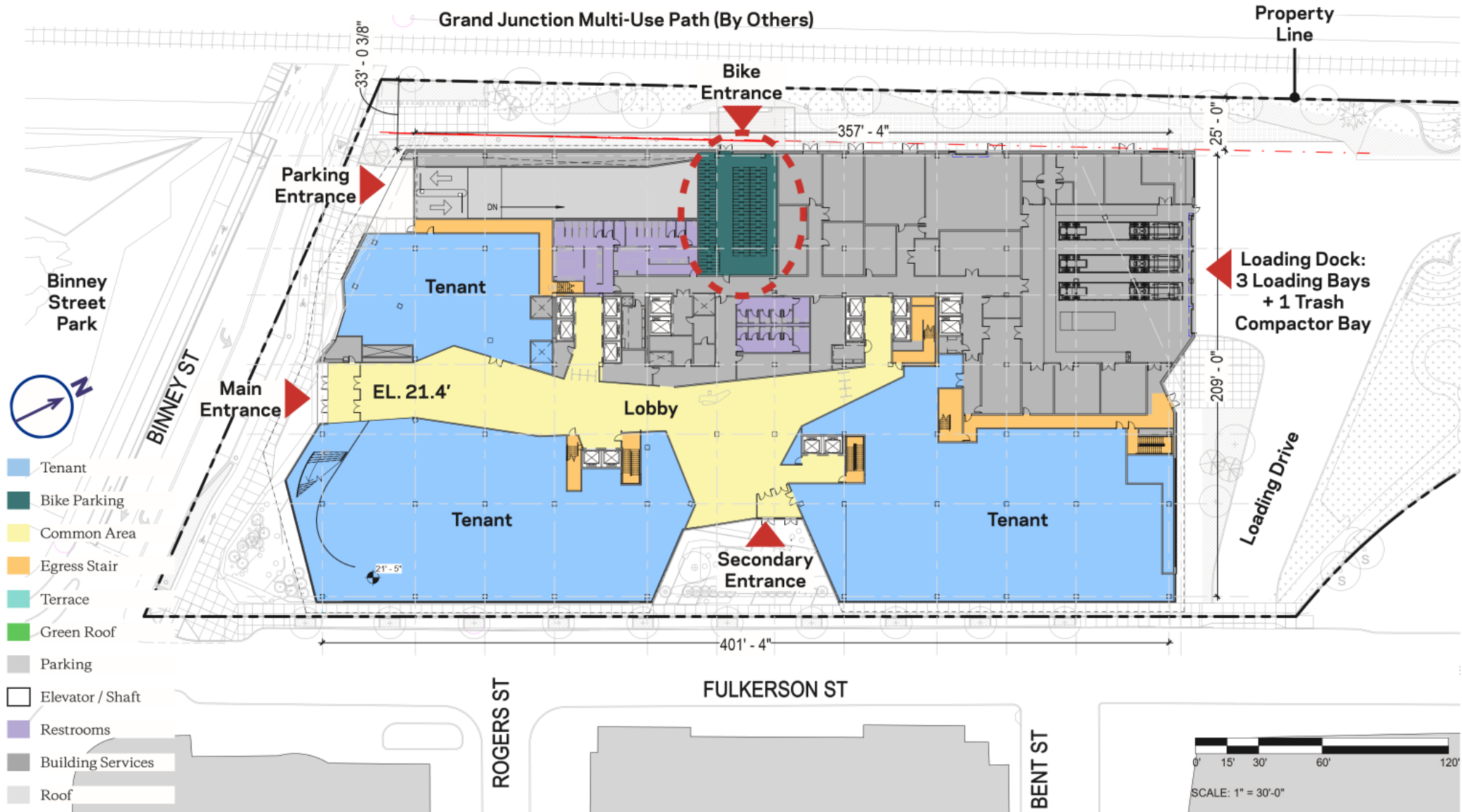

ALEXANDRIA



Ground Floor Plan

From Special Permit Application, August 2020

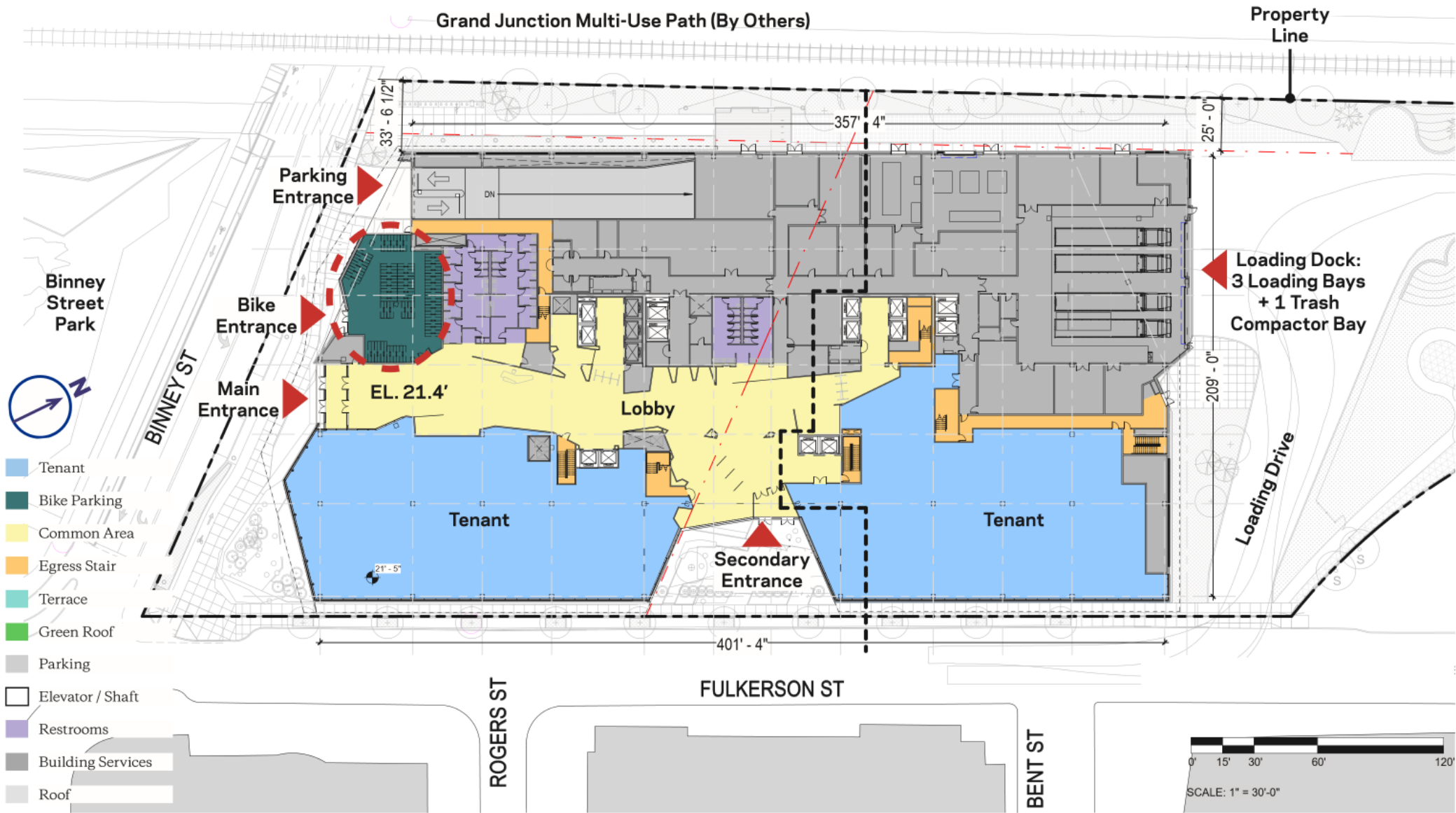

ALEXANDRIA



Ground Floor Plan

Updated

October 2020

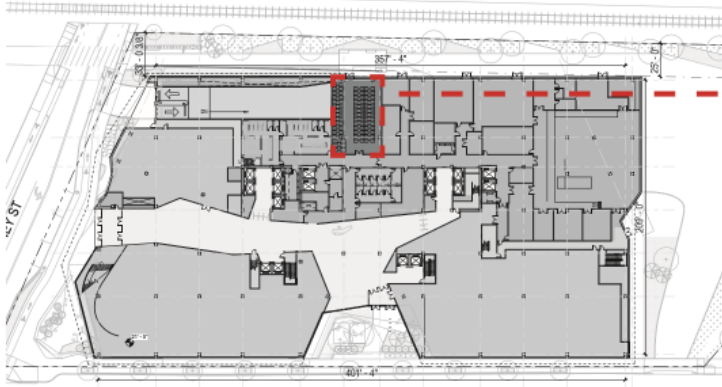

Long-Term Bicycle Parking

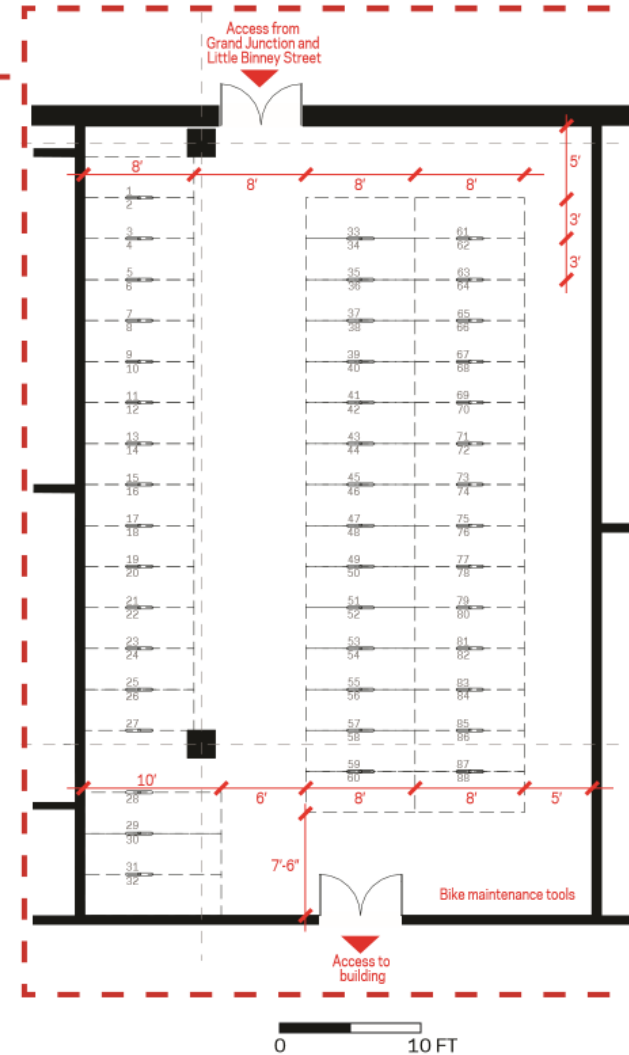

	Required	Provided
Short-Term Bicycle Parking (a)	23	24
Long-Term Bicycle Parking (b)	82	88
Large Long-Term Bicycle Parking (c)	5	5

(a) Short-Term Bicycle Parking:
0.06 x 370,462 GFA = 22 Spaces required.

(b) Long-Term Bicycle Parking:
0.22 x 370,462 GFA = 82 Spaces required.

(c) Large Long-Term Bicycle Parking:
Where 20 or more bicycle parking spaces are required, at least 5% of the spaces must be 10 feet long instead of 8 feet to allow space for tandems and trailers. These spaces are included in the long term bicycle parking count.



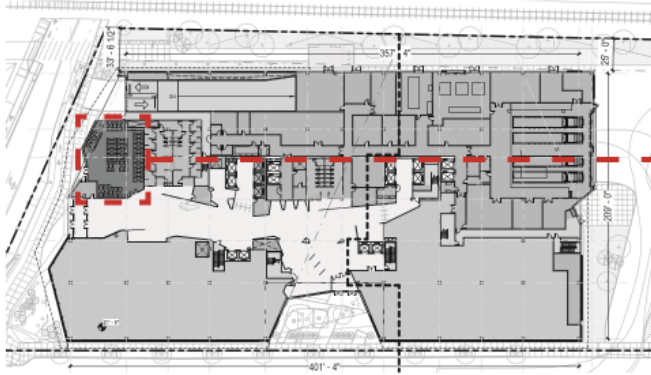

	Required	Provided
Short-Term Bicycle Parking (a)	23	24
Long-Term Bicycle Parking (b)	82	88
Large Long-Term Bicycle Parking (c)	5	5

(a) Short-Term Bicycle Parking:
0.06 x 370,462 GFA = 22 Spaces required.

(b) Long-Term Bicycle Parking:
0.22 x 370,462 GFA = 82 Spaces required.

(c) Large Long-Term Bicycle Parking:
Where 20 or more bicycle parking spaces are required, at least 5% of the spaces must be 10 feet long instead of 8 feet to allow space for tandems and trailers. These spaces are included in the long term bicycle parking count.

Long-Term Bicycle Parking

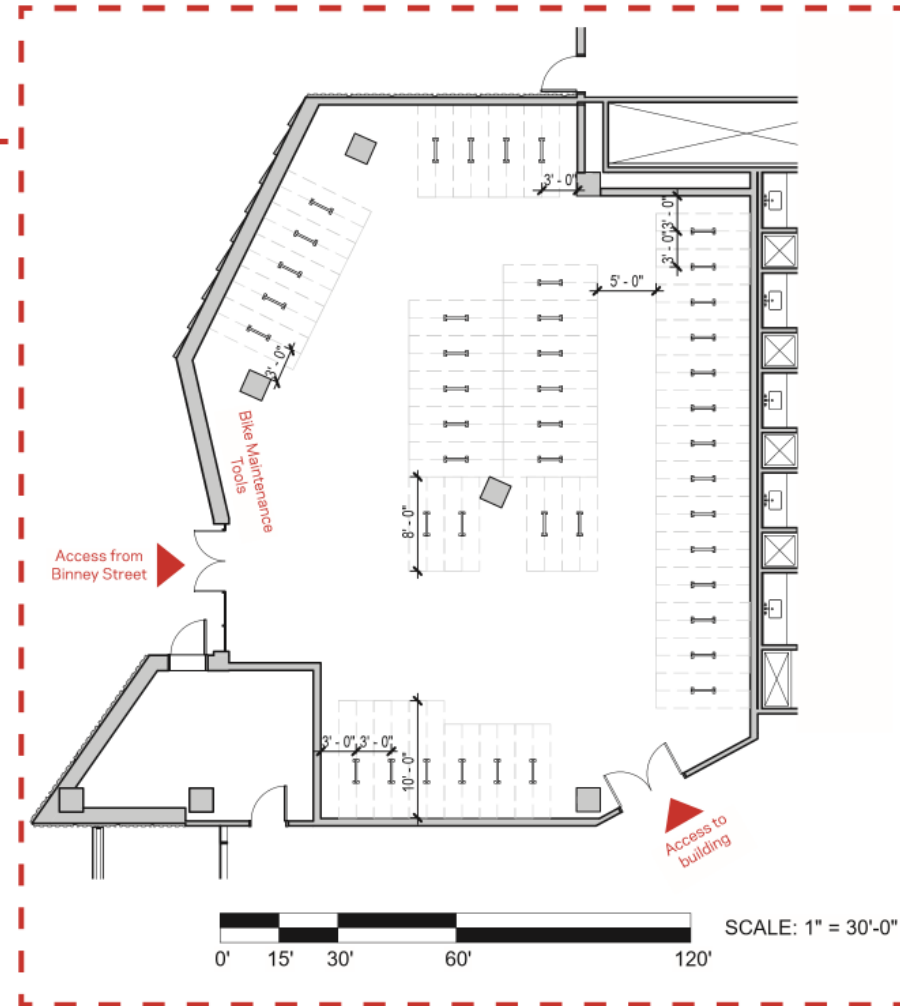



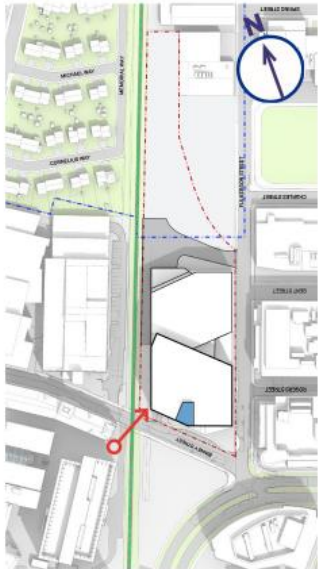

ALEXANDRIA

nbbj

View from West End of Little Binney Street

October 2020

18

Idea 1



Public comment

Public Comment Instructions

- Use the "Raise Hand" button to signal you have a question/comment. A staff member will then enable you to unmute yourself.
 - *9 to Raise Hand by phone
 - *6 to Mute/Unmute by phone
- Questions can also be submitted using the Q&A button.

Bottom Panel of
Zoom Screen

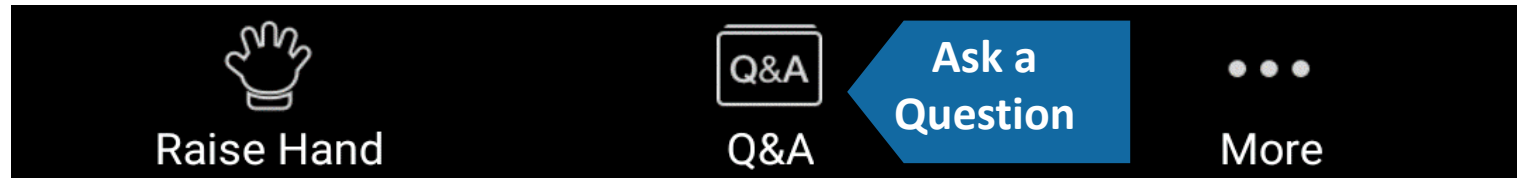



Bicycle Committee Work



Other Announcements



Thank You