



# Schoolyard Renovation at Amigos School

March 8, 2017

# Amigos School

Cambridge, Massachusetts

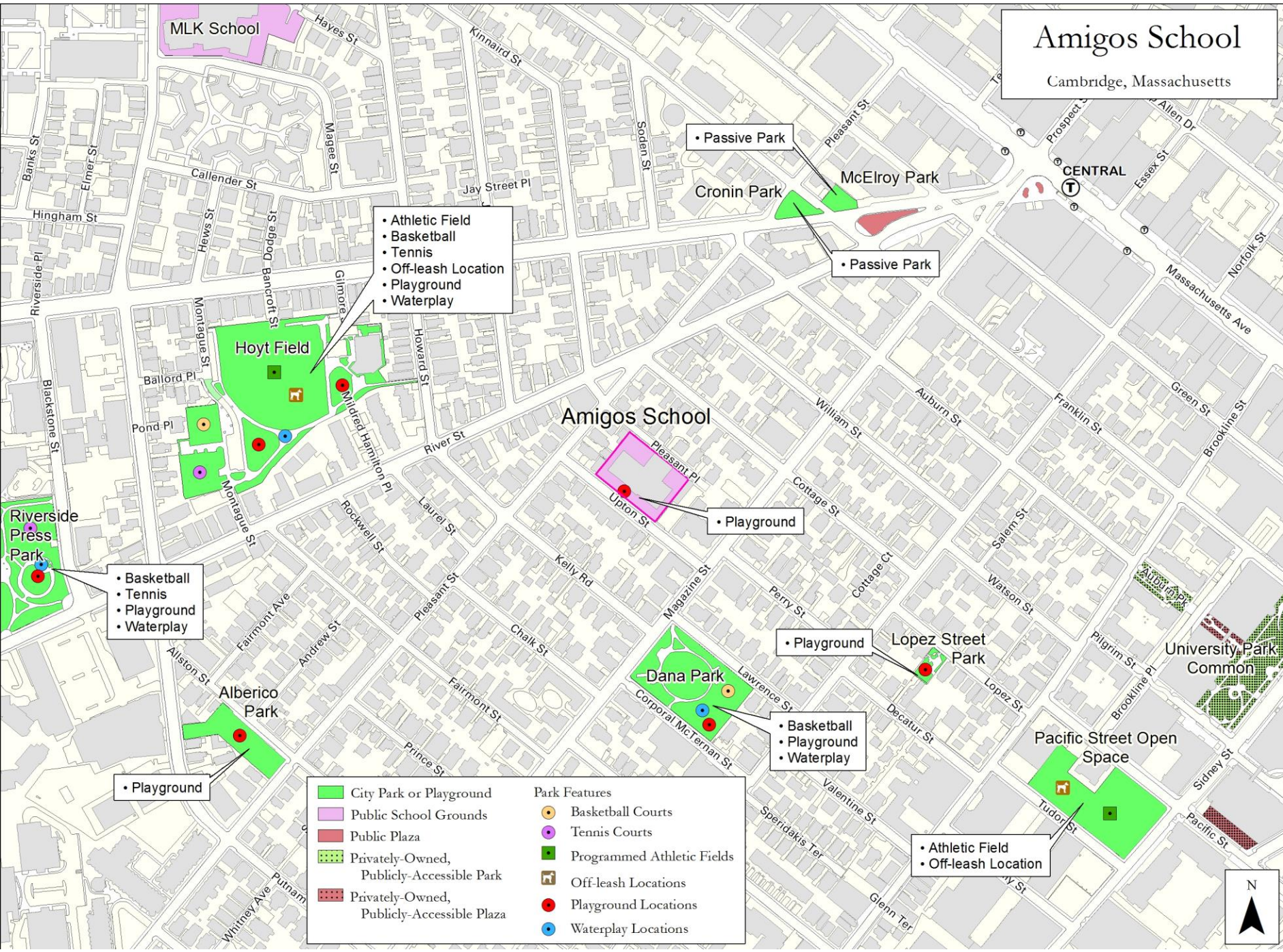

# AMIGOS SCHOOL DESIGN CONCEPT

CITY OF CAMBRIDGE

COMMUNITY DEVELOPMENT DEPARTMENT

2017

## ENCOURAGE MOVEMENT AND CREATIVE COLLABORATIVE PLAY



▲ NEW BACKBOARD



▲ BENCHES

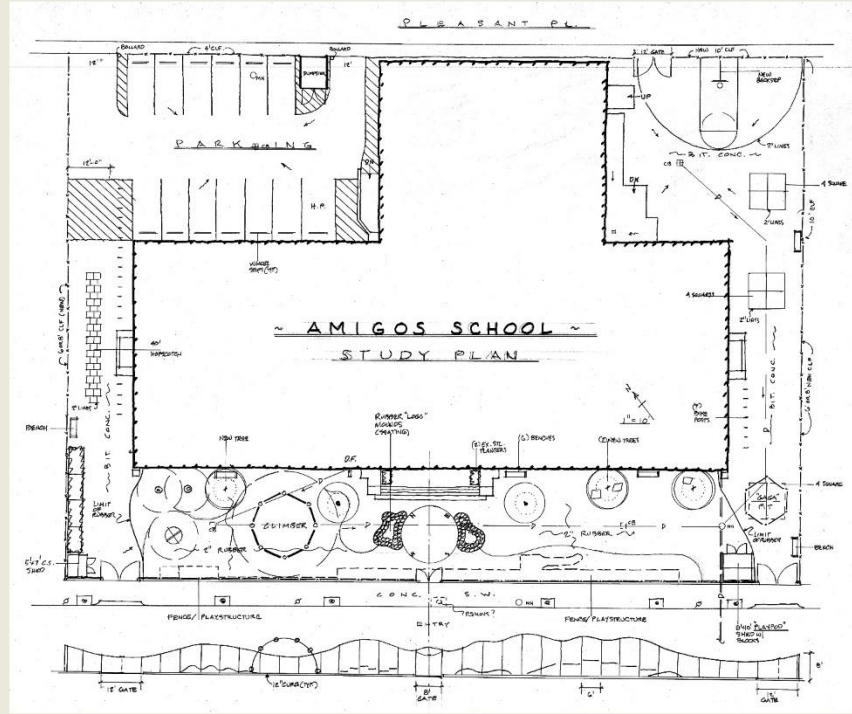

▲ AMIGOS SCHOOL STUDY PLAN



▲ PORTABLE GAGA PIT



▲ CLIMBING ▲ ▼



▲ LOOSE MATERIALS (IN SHED) ▲



▲ MOVEMENT PODS ▲



▲ SLIDE

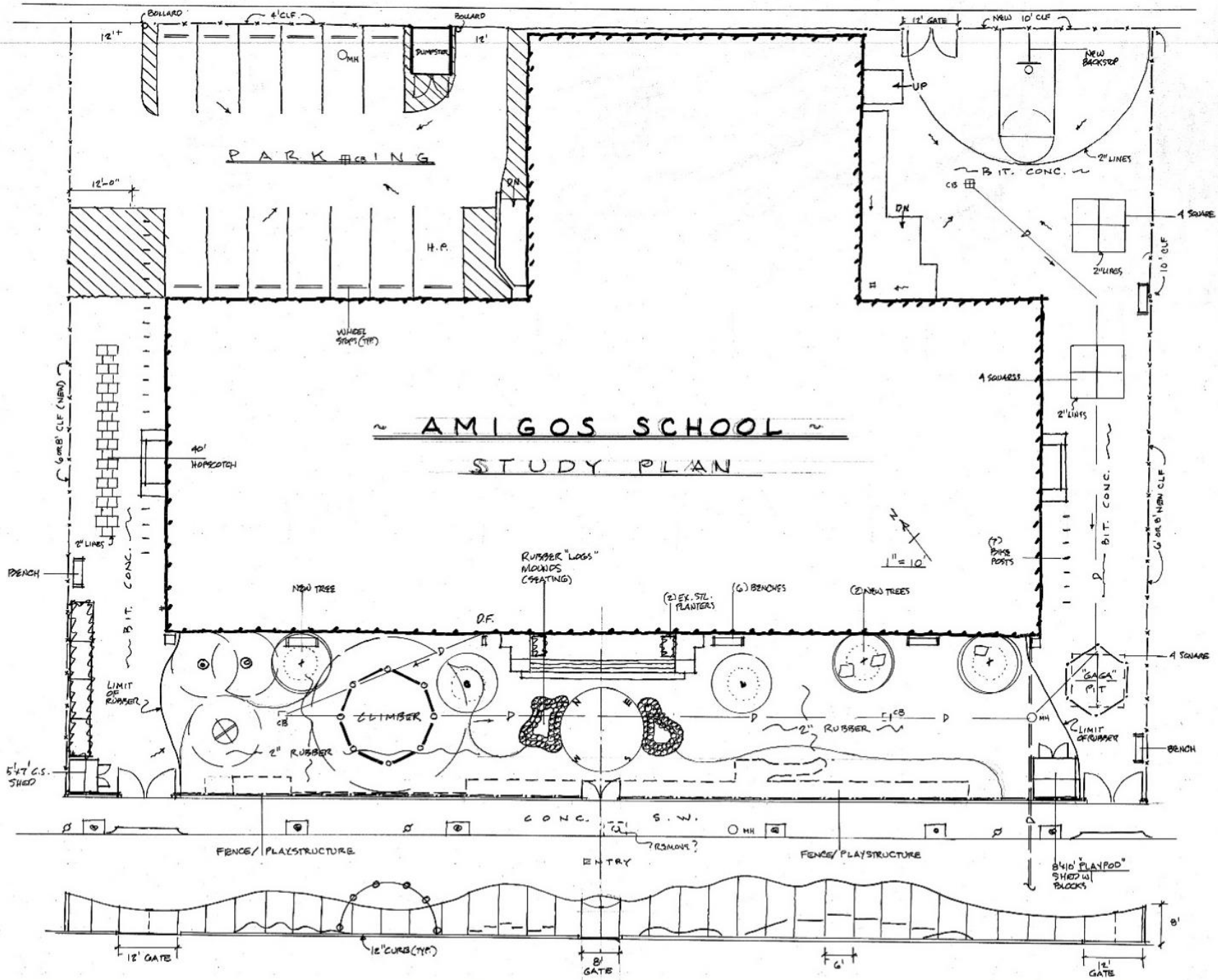

# AMIGOS SCH

## STUDY PLAN

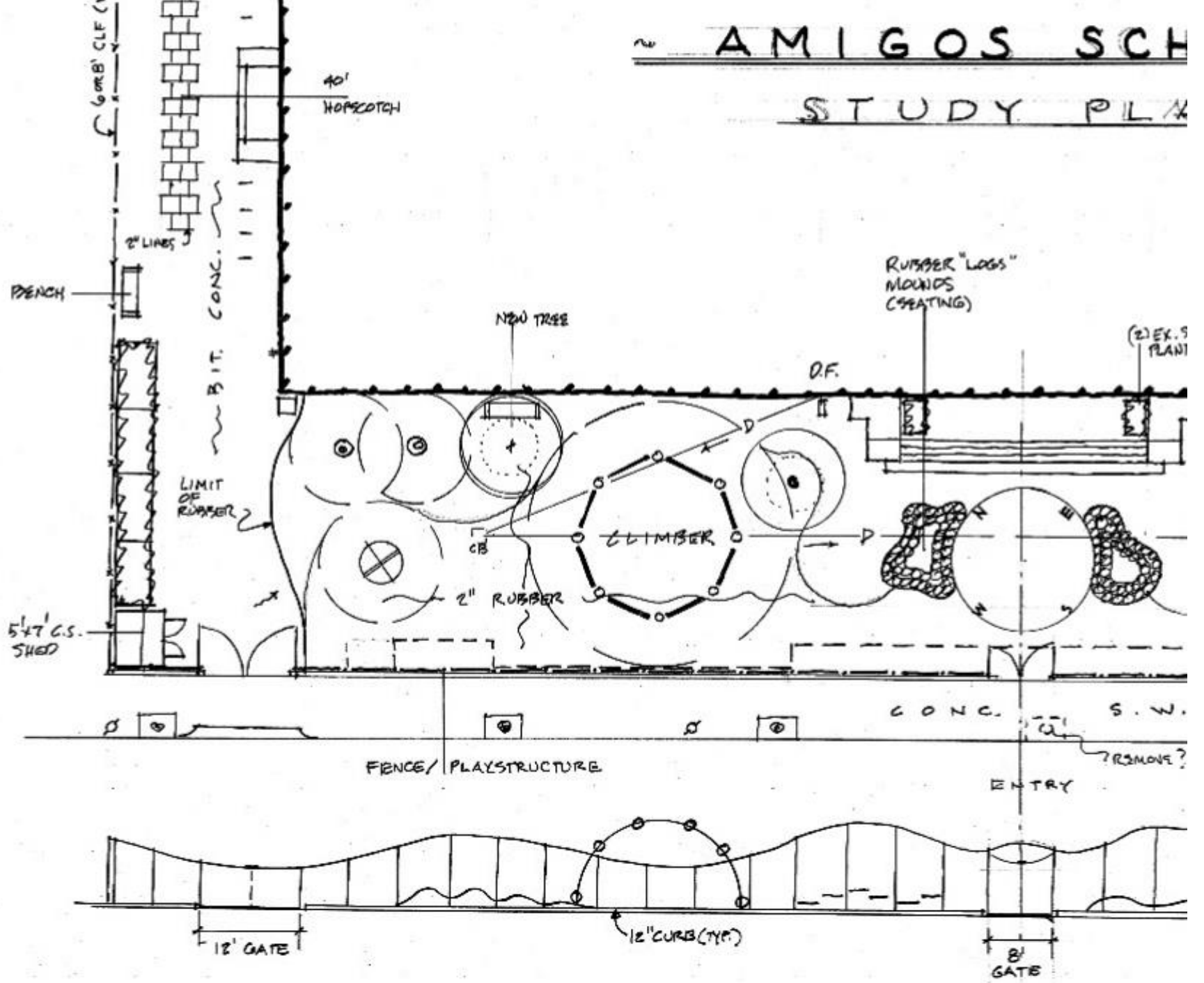

# GOS SCHOOL

## UDY PLAN

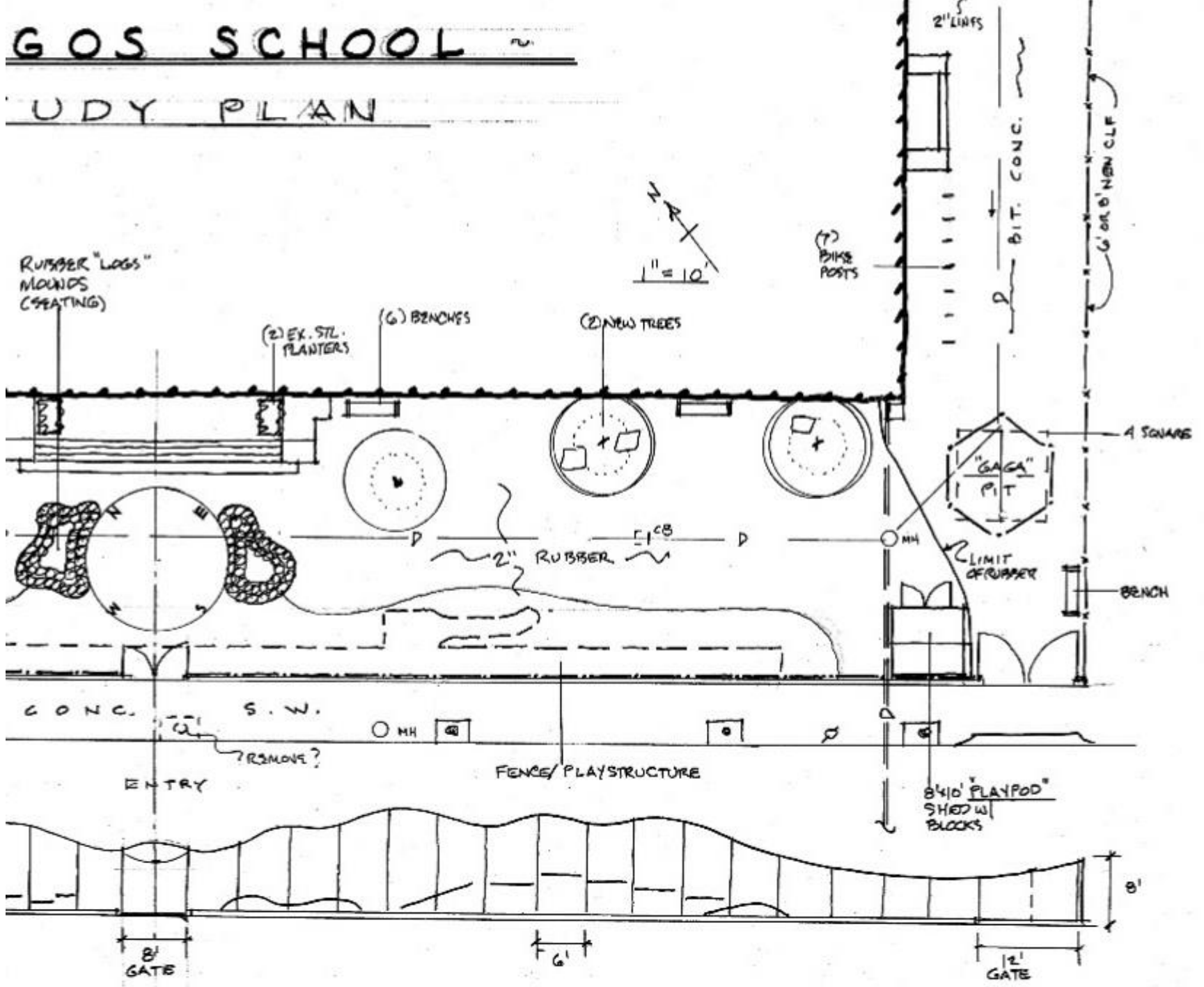

PLEASANT PL.

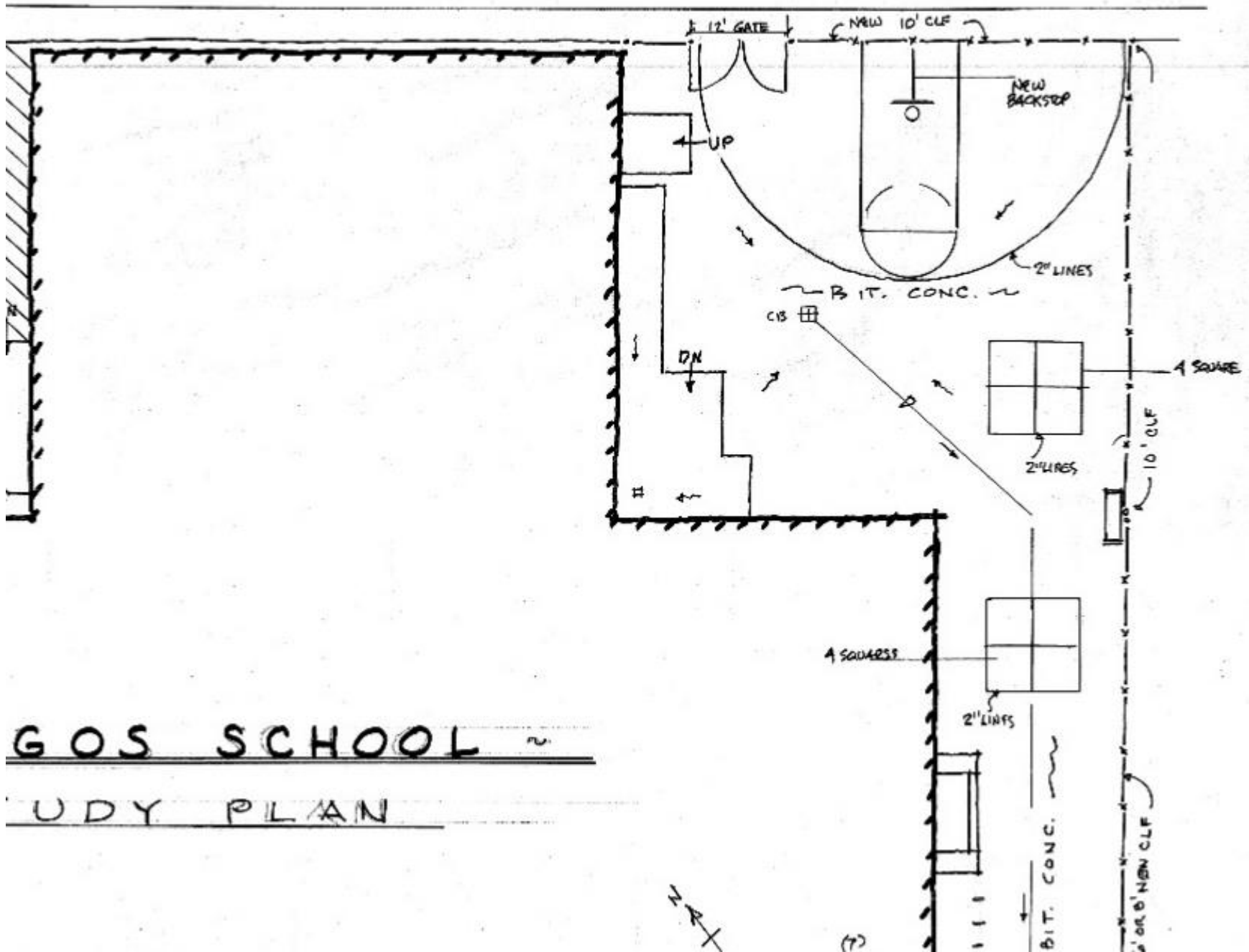

GOS SCHOOL

UDY PLAN

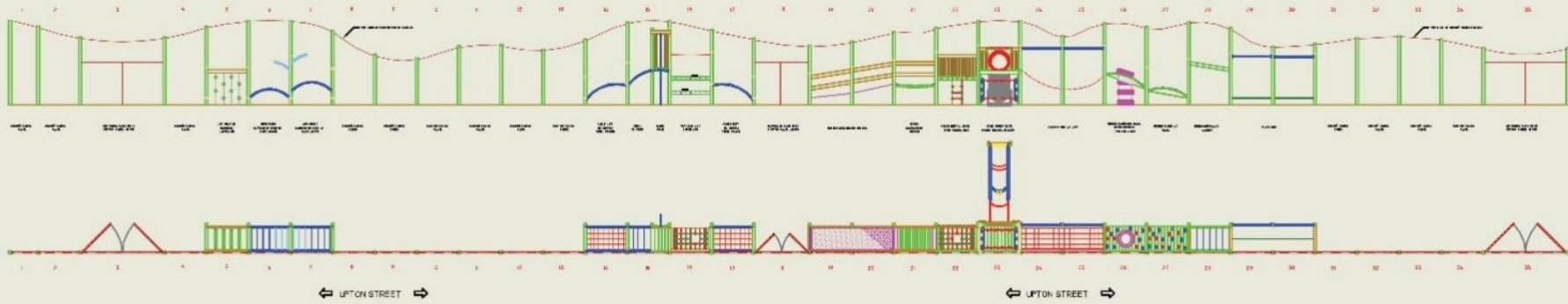

A resilient safety surface is recommended under and around all play structures.

<b>PlayVentures, Inc.</b>		tel: 800-799-7529	drawn by: <i>name</i>
1800 Monks Road, Unit 06, Warwick, PA 18976		fax: 215-675-8702	checked by: <i>date</i>
Title: Custom Designed PlayWood Plus School Age Playstructure		Customer: Amigos School Cambridge, MA	reference: <i>ref no</i>
			scale: <i>Scale to full size</i>
			adaptation: <i>Mark Nardone</i>
			drawing no. PVI-17616-0

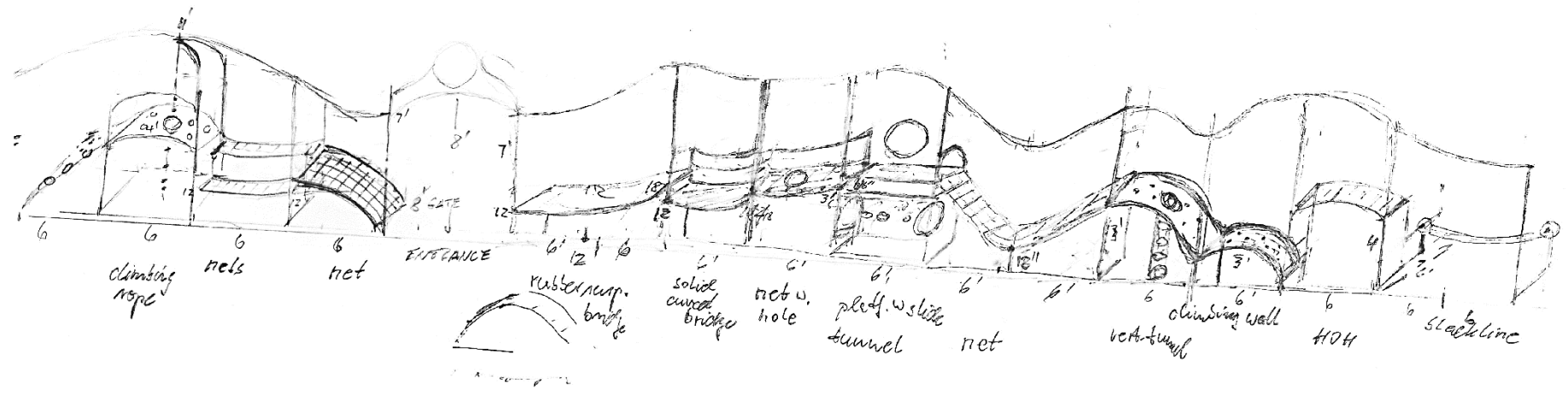
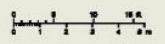



# AMIGOS SCHOOL DESIGN CONCEPT

CITY OF CAMBRIDGE

COMMUNITY DEVELOPMENT DEPARTMENT

2017

## ENCOURAGE MOVEMENT AND CREATIVE COLLABORATIVE PLAY

### PLAY FENCE ACTIVITIES

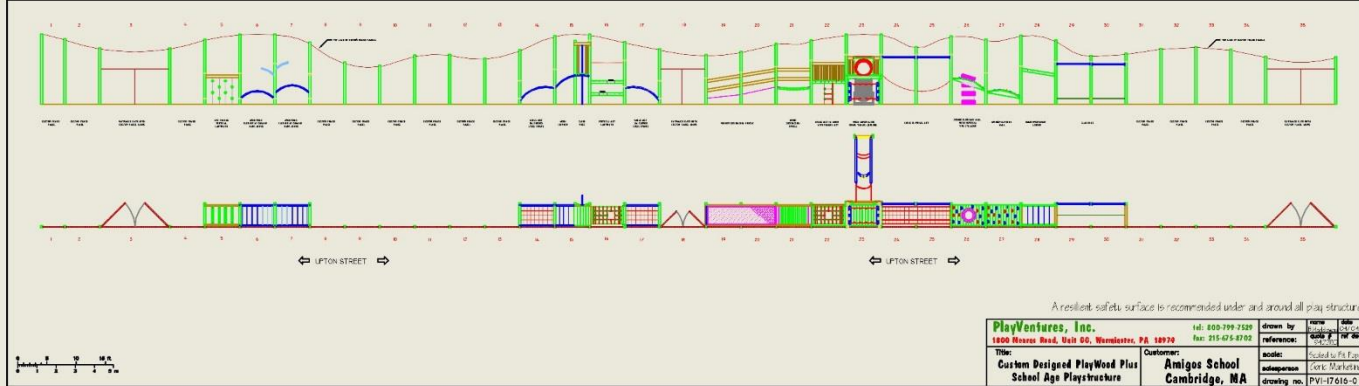

#### CRAWLING & TRAVERSING

Bridges, Tunnels - Plastic/Net, Open/Closed, Crawl Through Spaces



#### CLIMBING

Monkey Bars, Arched Climber, Rope Ladder, Hand-Over-Hand, Vertical/Inclined Net Climbers "Spider Webs"



#### PLAY FENCE ACTIVITIES - JUMPING

Bouncy Bridge



#### BALANCING & BRIDGING

Slacklines, Rope Bridges, Toddler/Wobble Bridges/Cat Walls, Tunnels, Stepping Pods



#### GATHERING & RESTING PLACES

Seating, Look Out & Resting Spots



#### Playground Structure Fencing & Gates





## Playground equipment plan view

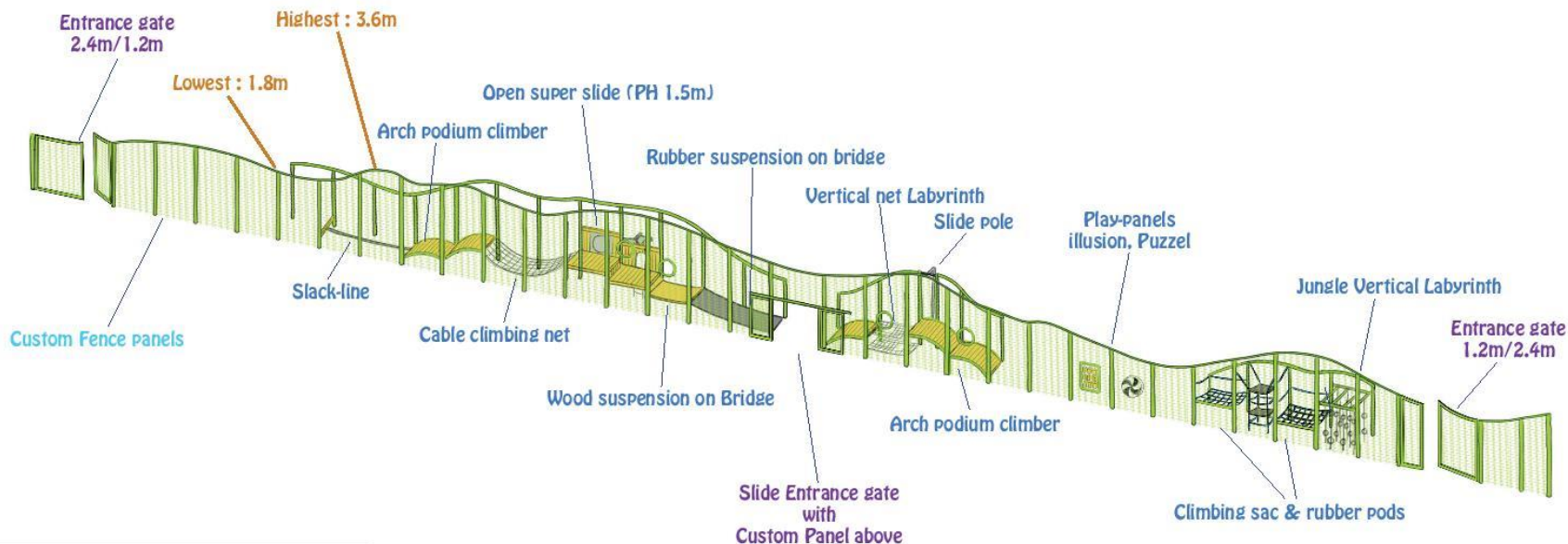

### Play-panels



Puzzle

illusion

### Play values

Active Play

Play theme : Body coordination, Climbing, Balance, Nets, Labyrinth, Play-panels

Total length : app. 67.3m

### Materials

Stainless steel (V2A) :  $\varnothing$ 10cm,  $\varnothing$ 4cm - Structure

Robinia woods - Podium, Play panel

Herculas rope - Cable, Nets

HPL-plate - Play panel

Rubber - rubber pods

### Color

Theme color: reed greed





## Playground equipment detail view Challenge 1.

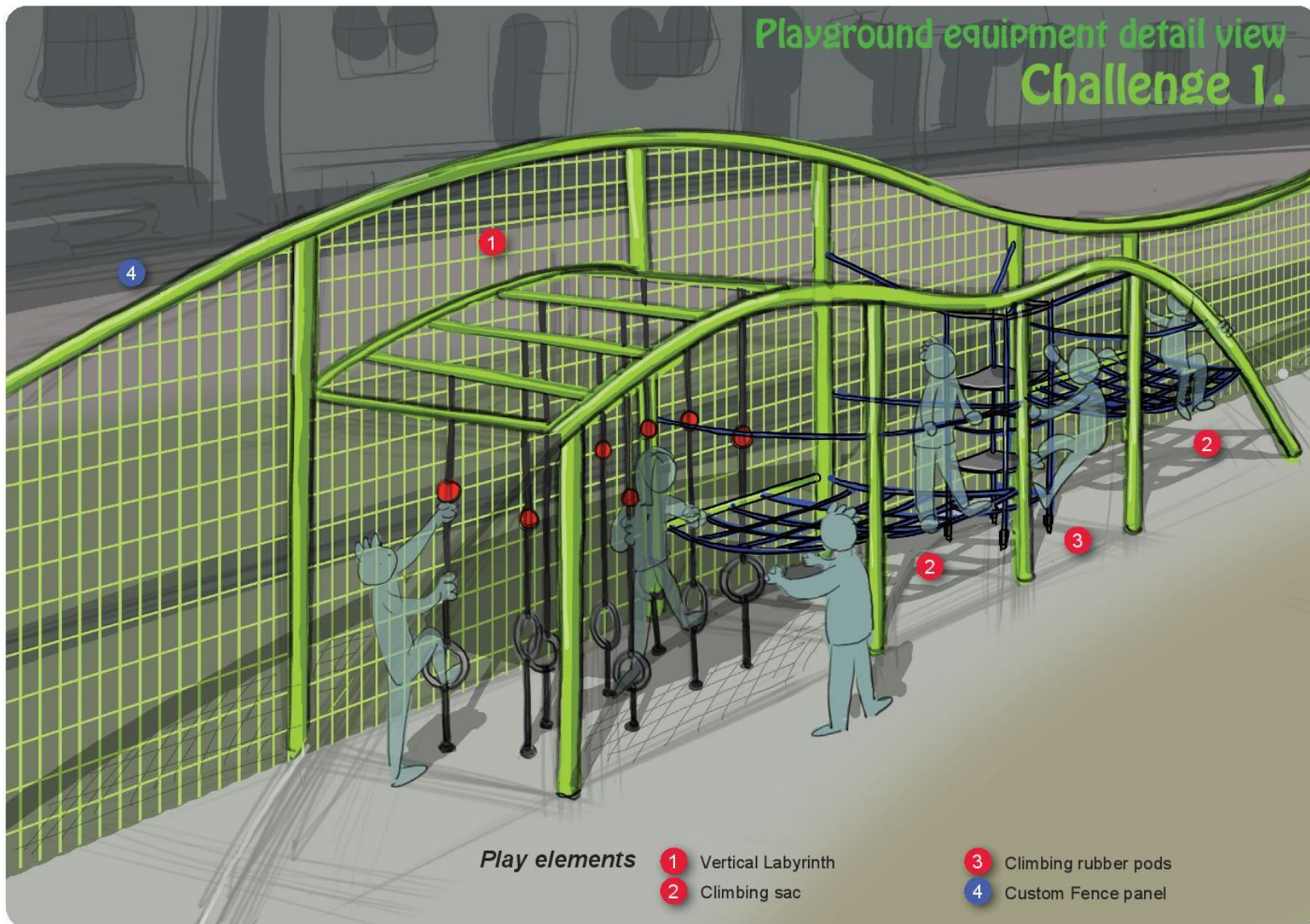



Playground equipment detail view  
**Challenge 2.**

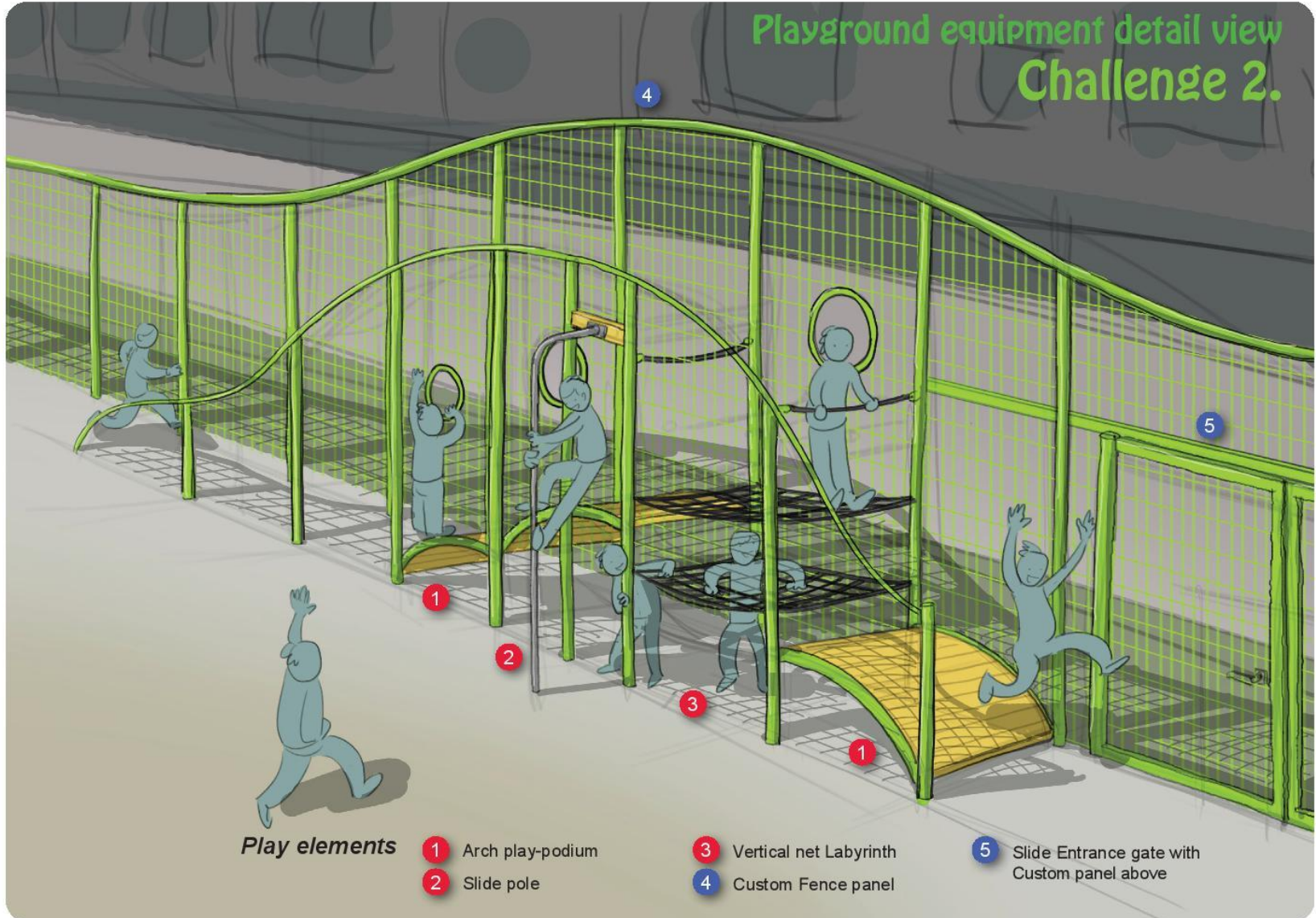

*Play elements*

- 1 Arch play-podium
- 3 Vertical net Labyrinth
- 2 Slide pole
- 4 Custom Fence panel
- 5 Slide Entrance gate with Custom panel above



Playground equipment detail view  
**Challenge 3.**

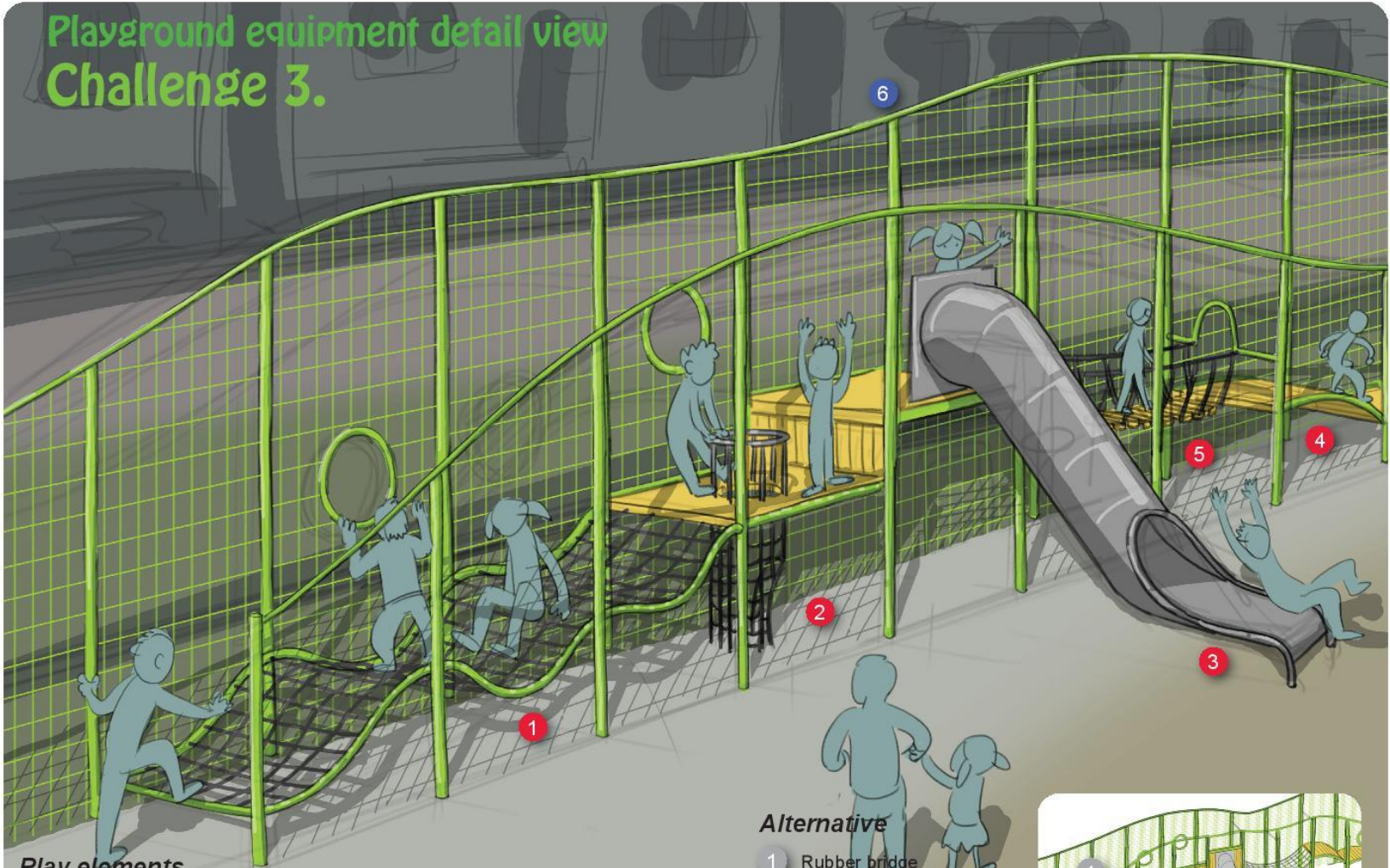

**Play elements**

- 1 Wave net-climbing
- 2 Vertical net-tunnel
- 3 Open super slide
- 4 Arch play-podium
- 5 Wobbly bridge
- 6 Custom Fence panel

**Alternative**

- 1 Rubber bridge
- 2 Webby bridge
- 3 Cable climbing net

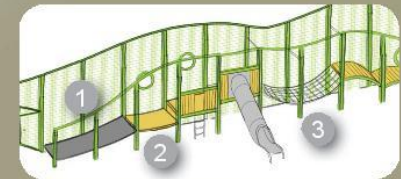

Alternative play-combination