

---

City of Cambridge  
Community Development Department

# Transit Advisory Committee

April 2023

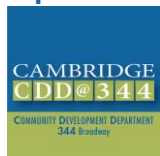



# Welcome

## **Purpose**

Get feedback from appointed members of the TAC, the City's "community experts"

## **Outcomes**

City staff understand TAC member feedback for city projects

## **Process**

TAC to 'raise hand' during presentations and discussions

Public to type in questions in zoom Q&A or speak verbal comments during public comment period



# City Updates

# Selected street projects





# Mass Ave 4 – Harvard Square Bus Stops

Want to hear your thoughts regarding design issues for the bus stop boarding islands

- Dawes Island
- **Johnston Gate**
- Holyoke Gate
- Bow Street

City staff are also asking feedback from other advisory committees

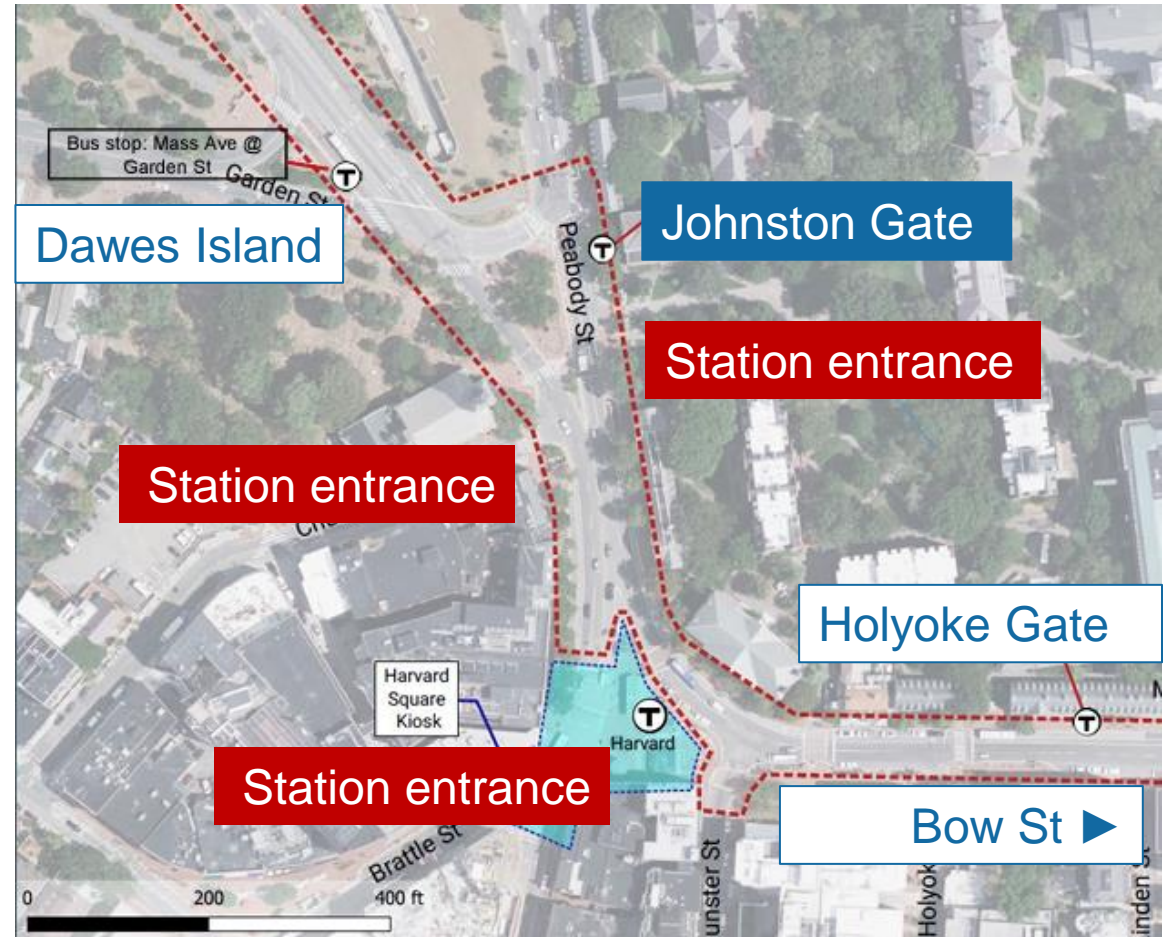

# Mass Ave 4 – Harvard Square Bus Stops



Review a design challenge



Your feedback



Summarize

# Mass Ave 4 – Harvard Square Bus Stops

Origin of this project is the Cycling Safety Ordinance

This is an area where separated bike lanes are challenging to install with quick-build methods, including:

- frequent buses
- conflicts between buses and cyclists
- conflicts between bus riders and cyclists

Proposing boarding islands as ways to manage these conflicts

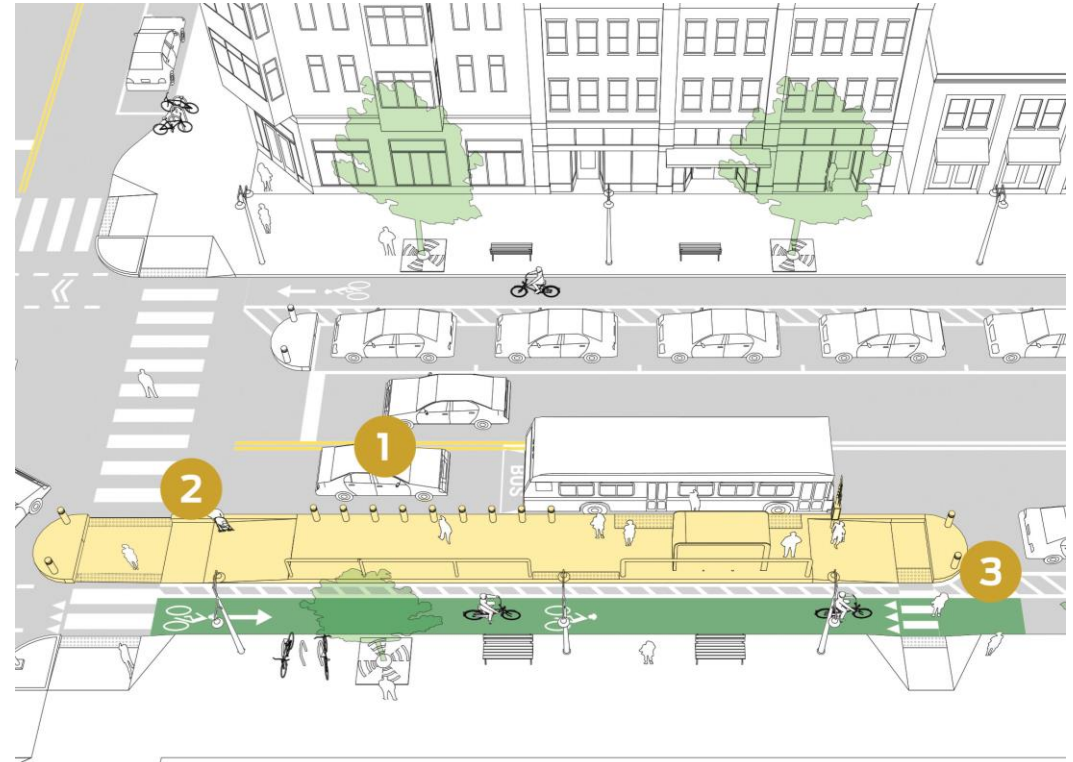

Source: NACTO Transit Street Design Guide



# Mass Ave 4 – Harvard Square Bus Stops

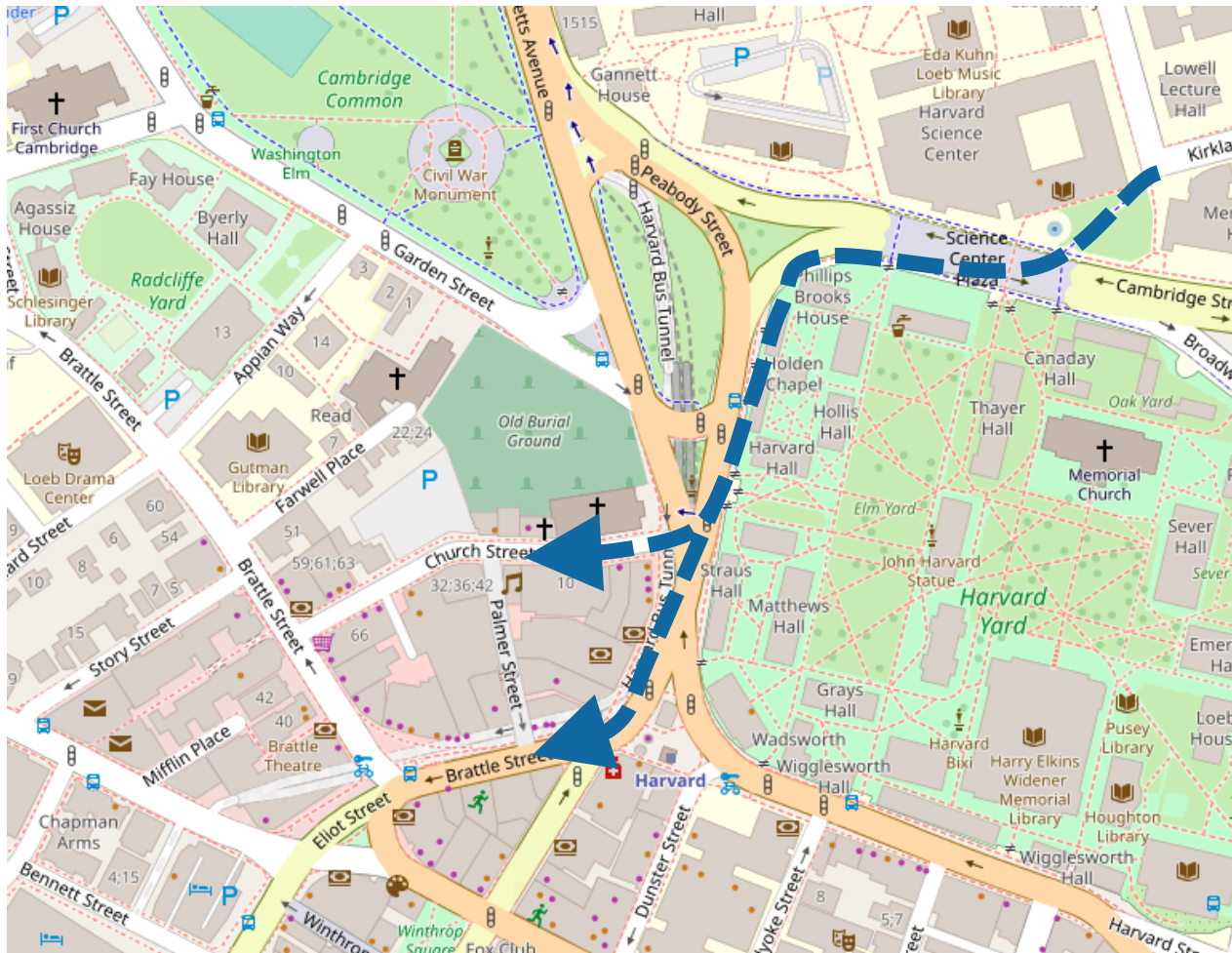

With feedback since our last public event in October 2022, one feedback that we heard was that the design should accommodate a cycle route from Science Center Plaza to Church Street and Brattle Square/Mount Auburn



# Mass Ave 4 – Harvard Square Bus Stops

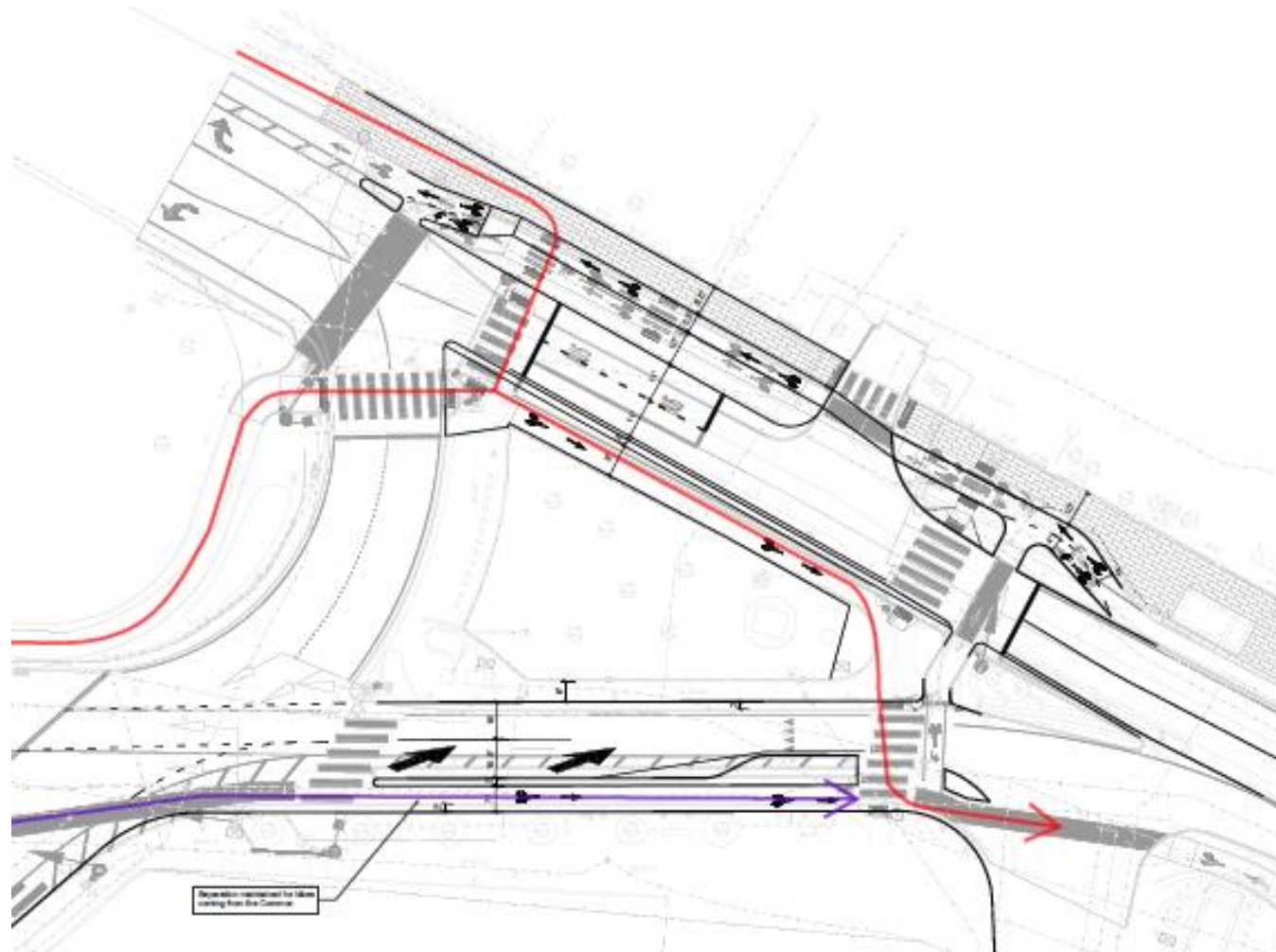

# Mass Ave 4 – Harvard Square Bus Stops

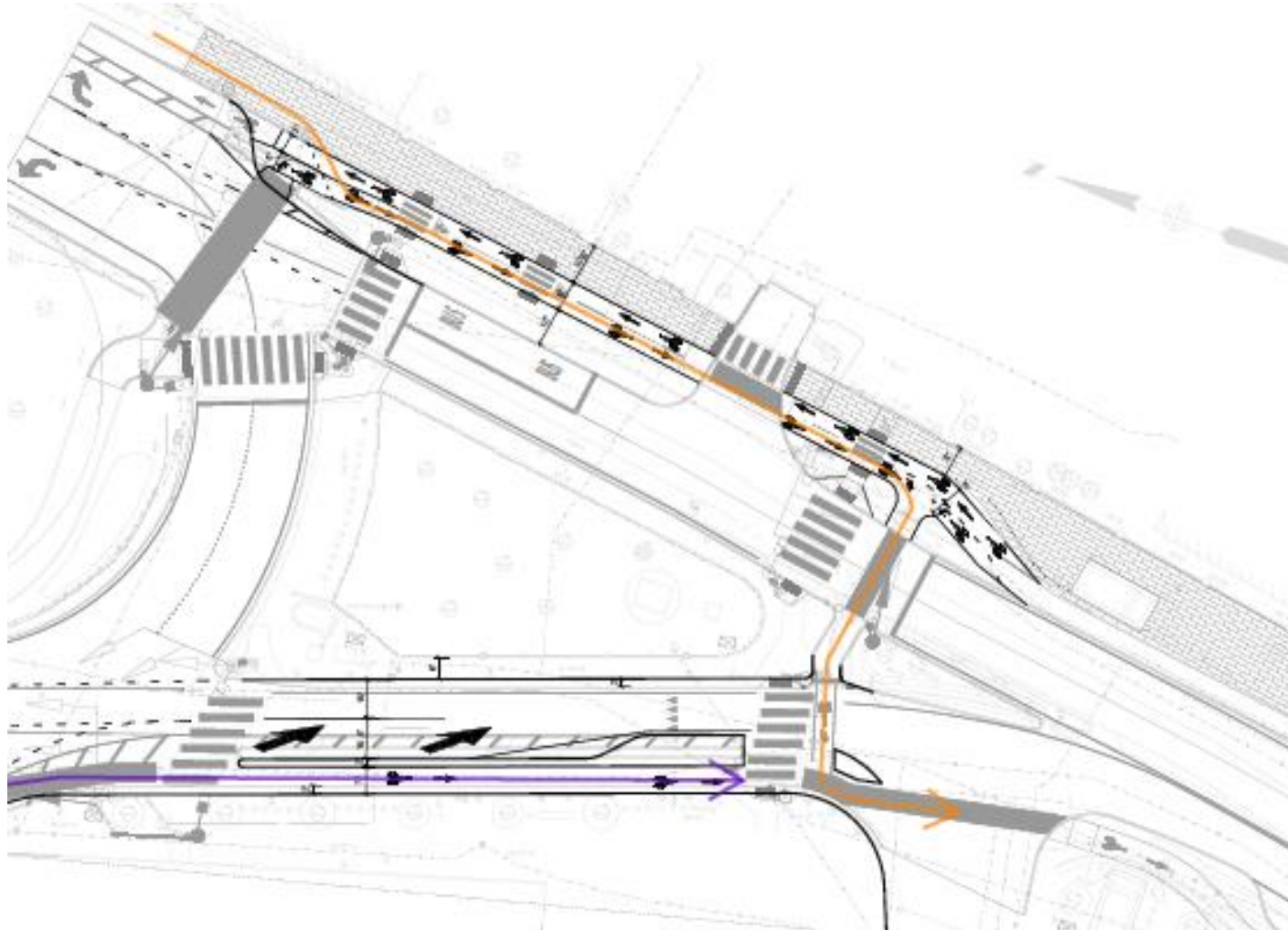

# Mass Ave 4 – Harvard Square Bus Stops

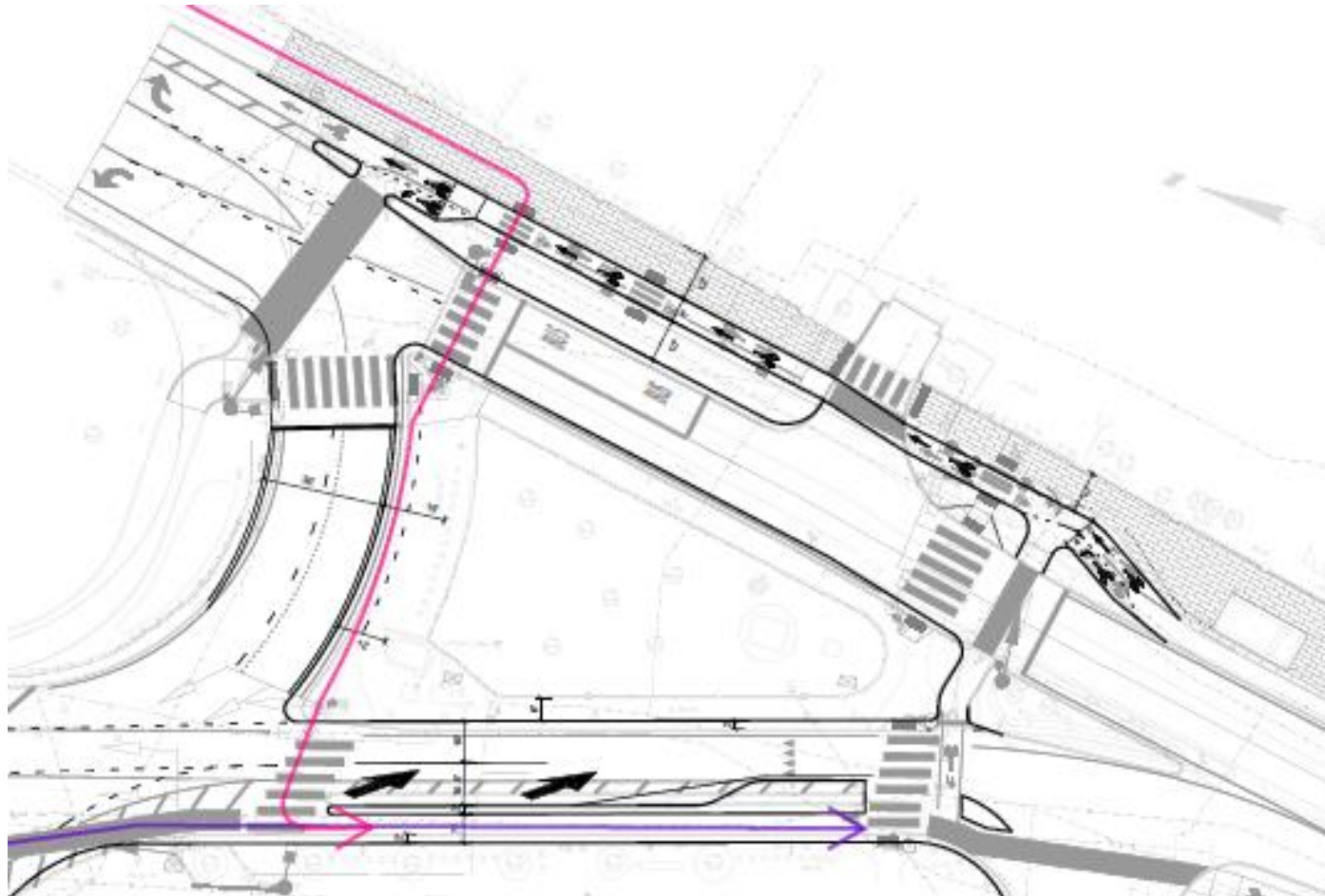



# Mass Ave 4 – Harvard Square Bus Stops

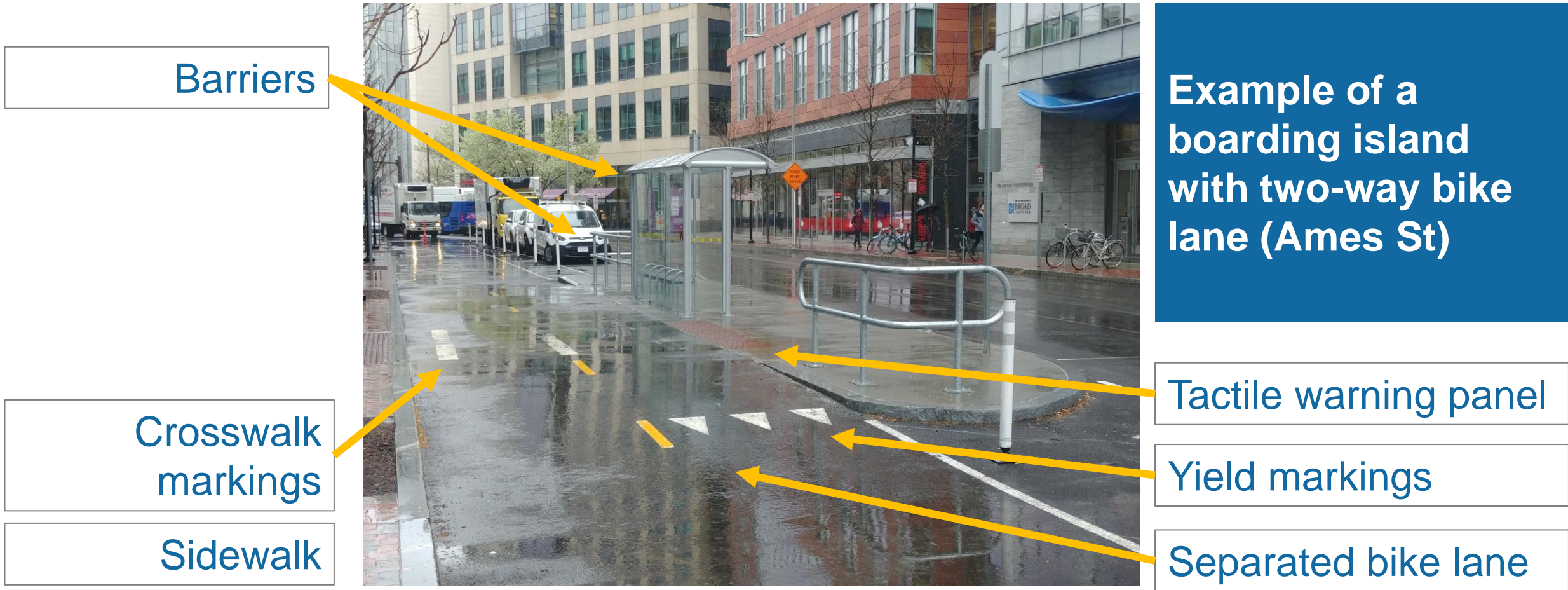

Barriers

Crosswalk markings

Sidewalk

Example of a boarding island with two-way bike lane (Ames St)

Tactile warning panel

Yield markings

Separated bike lane



# Mass Ave 4 – Harvard Square Bus Stops



Barrier

Example of a boarding island with one-way bike lane (Inman Sq)

Crosswalk markings

Tactile warning panel

Sidewalk

Separated bike lane



# Mass Ave 4 – Harvard Square Bus Stops

Some questions for the advisory committee:

- What design details should we be considering as we move into final design?
- Have you experienced the two stops in the examples? What from those experiences are relevant for the conversation today?
- Do you have suggestions of other locations that the project team should look at for precedent research?



# Updates: Other City Projects

# Inman Square

Remaining work is primarily for the new pedestrian plaza, identified in the green area

Final paving and markings remain for the streets inside the blue outlined space

Expected to be complete later this year

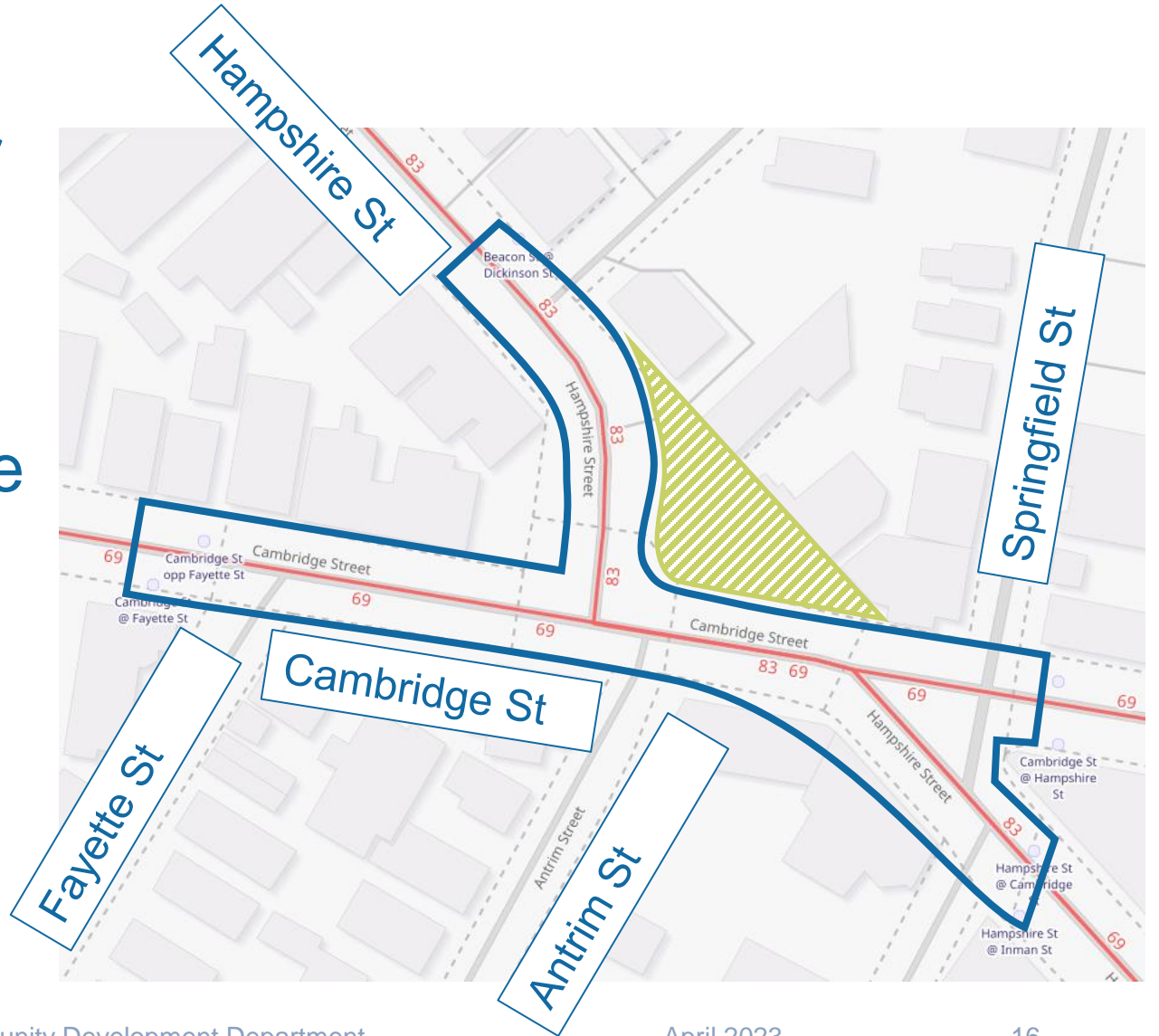



# Locations with projects in implementation

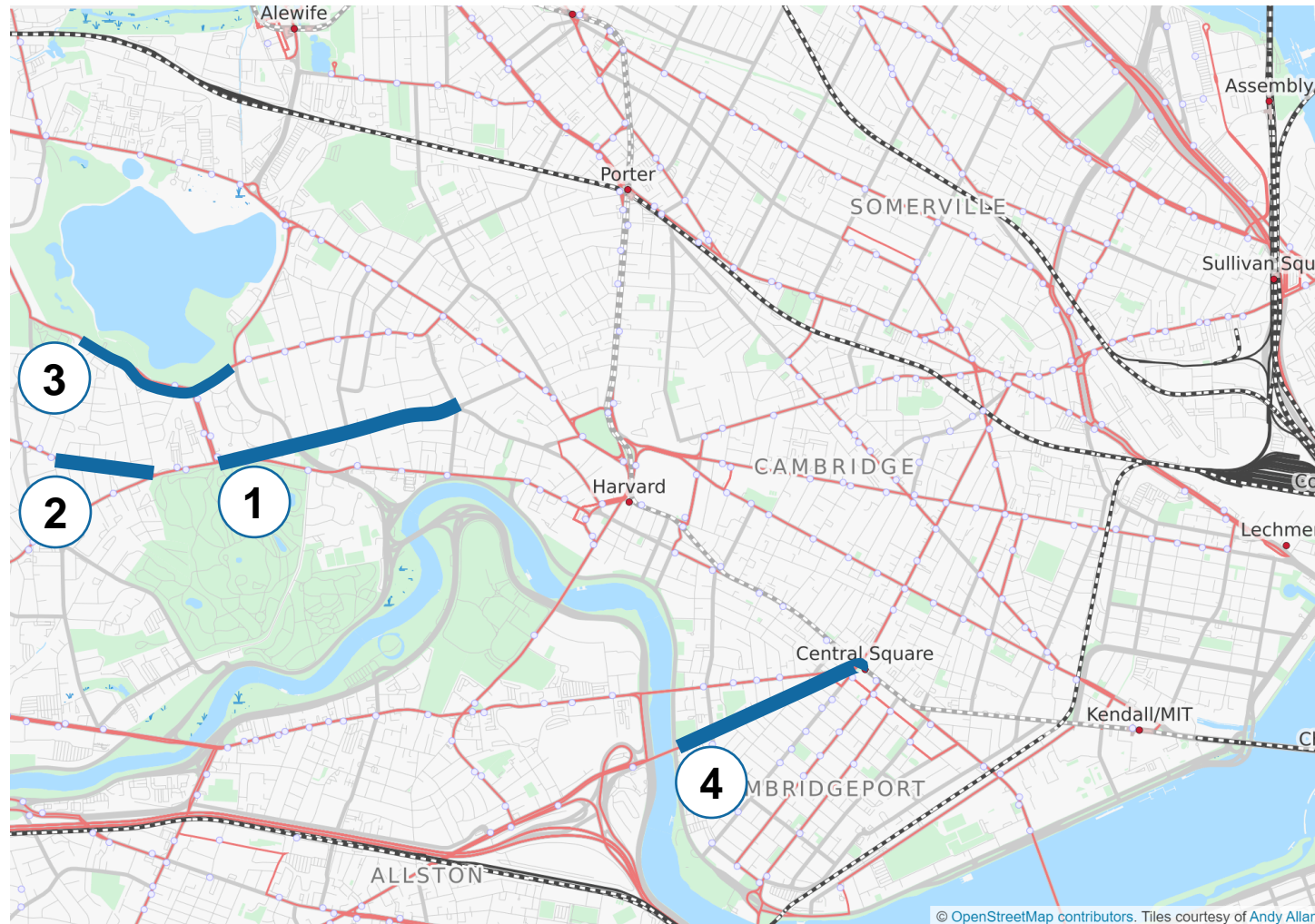

**Number** – Project name

- ① Brattle Street Safety Improvements
- ② Belmont Street Reconstruction
- ③ Huron Avenue Glacken Field Connectivity
- ④ River Street Reconstruction



# Implementation soon

Project	Update	Next public event
<b>Brattle Street CSO</b>	Phase 2 implementation began	
<b>Belmont Street Project</b>	Builders beginning work	
<b>Huron Avenue – Glacken Field Project</b>	Builders beginning work	
<b>River Street Reconstruction Project</b>	Builders beginning work	

# Locations with projects in design

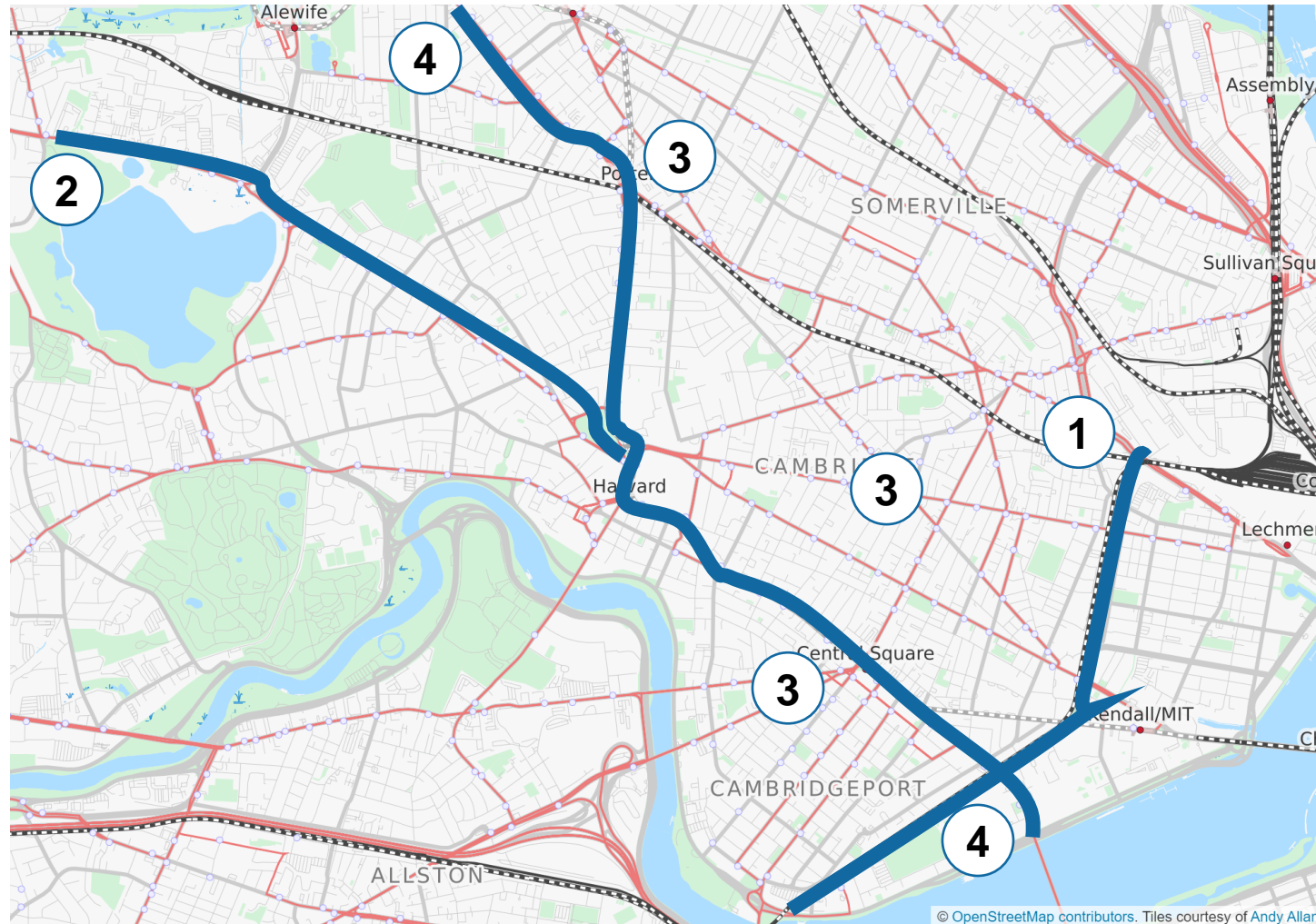

**Number** – Project name

- ① Grand Junction MUP
- ② Concord Avenue Transit Signal Priority
- ③ Bus Realtime Signage
- ④ Transit Signal Priority

# In planning and design

Project	Update	Next public event
<b>Grand Junction MUP Project</b>	Continuing to work on final design plans	Public meeting expected now to spring - TBA
<b>Concord Ave – Transit Signal Priority Project</b>	Working with MBTA on procurement	
<b>Real-time Transit Signage (PB 2017)</b>	Procurement underway for late April bid opening	
<b>Transit signal priority (PB 2016)</b>	Working with MBTA on procurement for Mass Ave signal priority upgrades	



# Locations with projects in study

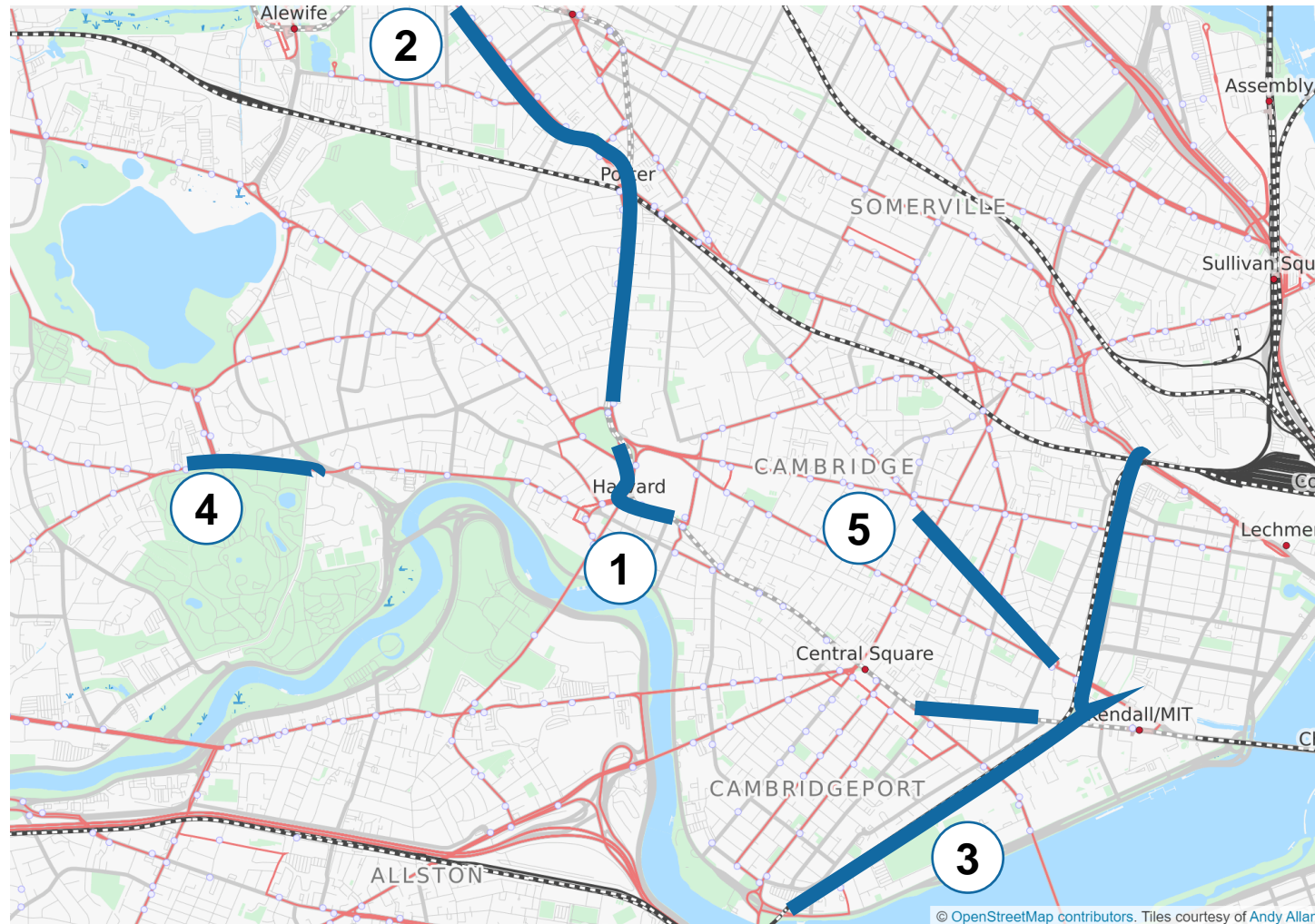

## Number – Project name

- ① MassAve4 Harvard Square Bus Stops
- ② MassAve4 Harvard to Alewife Brook Parkway
- ③ Grand Junction Transit
- ④ Mt. Auburn/Aberdeen
- ⑤ Hampshire St CSO



# Under study

Project	Update	Next public event
<b>Harvard Square Area (MassAve4 Harvard Bus Stops)</b>	50% design completion; planning for outreach	TBA – Joint meeting
<b>MassAve4 (Harvard to Alewife Brook)</b>	To develop conceptual designs	TBC
<b>Grand Junction Transit</b>	CRA to study transit on GJ	Potentially May-June
<b>Mt Auburn/Aberdeen</b>	To build new signal at Aberdeen (Bus lanes?)	TBA - Potentially May
<b>Hampshire St CSO</b>	City to build SBLs + relocate bus stops	TBA



# Updates: Transit Advisory Committee



# Announcements

- Recruitment began at end of March and will continue to May 1
  - Please send me an e-mail to confirm that you would like to continue for another 2-year term
- Governor approved remote participation in public meetings until March 2025
  - Intend to continue to meet regularly using remote participation
  - Do you have any thoughts about when we should do in-person meetings?





# Upcoming Meetings

- Next MBTA project subcommittee meeting
  - Thursday, April 20, 2023



# Upcoming Meetings

- Next Transit Advisory Committee meeting
  - Thursday, May 4, 2023
  - Thursday, June 1, 2023
    - Potential presenters include CRA on recent studies
- Scheduled joint meetings of Transit Advisory, Bicycle, Pedestrian Committees
  - Wednesday, April 19, 2023 – DPW Five-year Street & Sidewalk Reconstruction plan - Bring your questions re: streets with transit
  - Wednesday, May 17, 2023

Thank you for participating in this Transit  
Advisory Committee meeting.

**Stay healthy and cool tonight.**

---

**Thank You**