

- NOTES:**
- CONTRACTOR SHALL MAINTAIN EXISTING UTILITY COVERS AND CASTINGS TO ALL INTERMEDIATE AND FINAL GRADES. CONTRACTOR TO COORDINATE WITH RESPECTIVE UTILITY COMPANIES FOR GAS/TELECOM/ABLEELECTRIC.
 - ALL VERTICAL GRANITE CURBING WITHIN WORK LIMITS SHALL BE REMOVED AND RESET UNLESS OTHERWISE NOTED. AUTHORIZATION FROM THE RESIDENT ENGINEER OR CITY OF CAMBRIDGE IS REQUIRED FOR ANY OTHER REMOVAL WITHOUT AUTHORIZATION FROM THE RESIDENT ENGINEER OR CITY OF CAMBRIDGE.
 - AT LOCATIONS WITH EXISTING TREES TO REMAIN, CONTRACTOR SHALL MAINTAIN 8\"/>

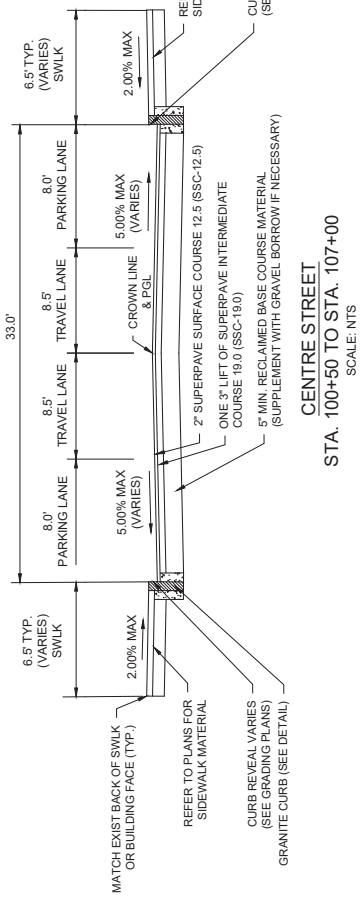

CENTRE STREET
 STA. 100+50 TO STA. 107+00
 SCALE: NTS

ISSUED FOR BID

		Client CITY OF CAMBRIDGE, MASSACHUSETTS	Sheet R-1
Scale AS NOTED	Date JANUARY 2024	Project CHAPTER 90 CONTRACT 25 ROADWAY IMPROVEMENT PROJECT	File No. 11393
Job No. 2023108.020A	Designed by JPP/PG	Drawing CENTRE STREET - CONSTRUCTION PLAN	
Drawn by ALZ/GLD	Checked by PFB	No. BMS	
Approved by BMS	Description REVISIONS	Date	



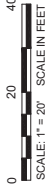
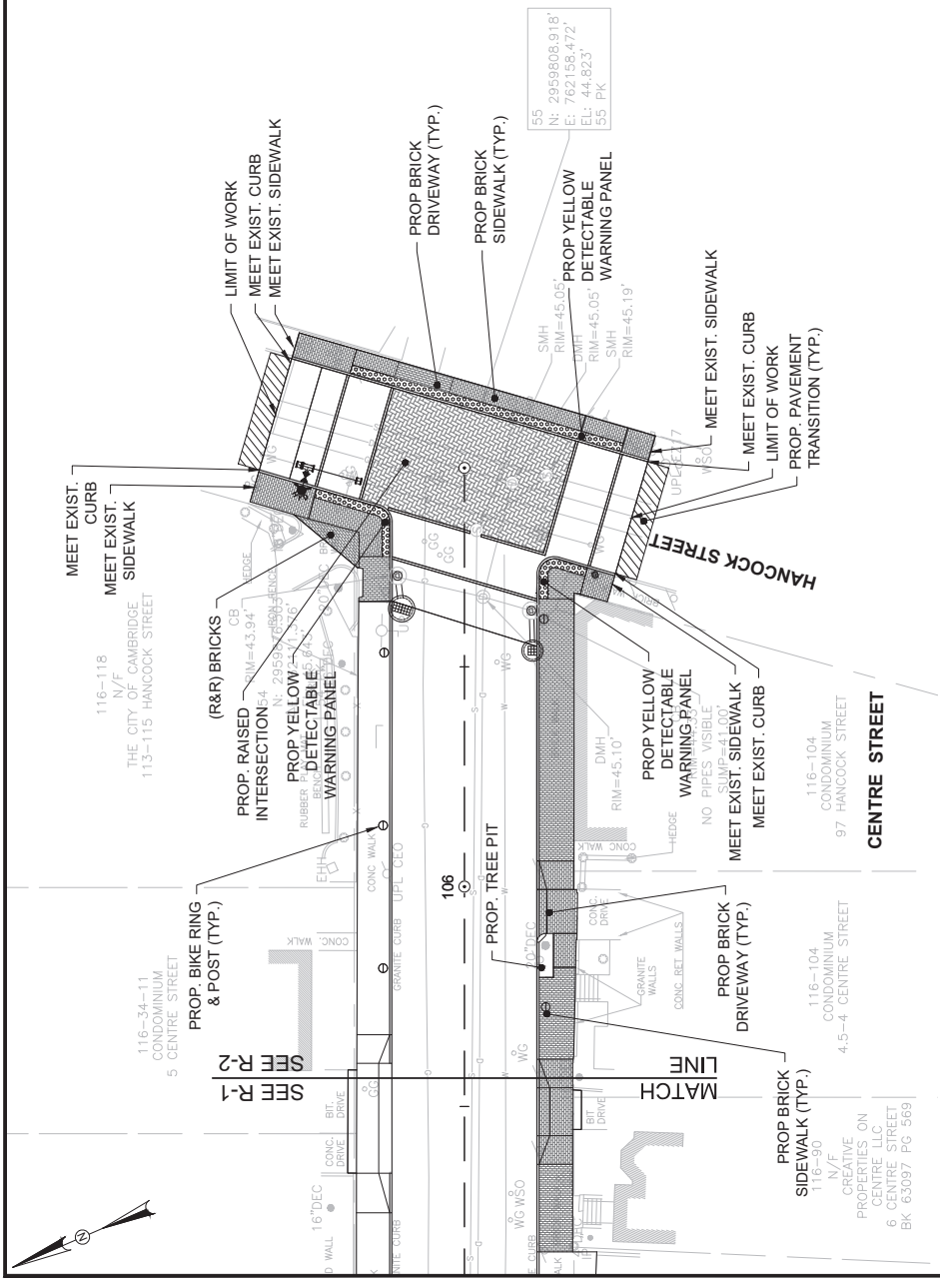
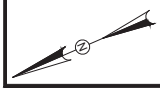

NOTES:

- CONTRACTOR SHALL ADJUST EXISTING UTILITY COVERS AND CASTINGS TO ALL INTERM AND FINAL GRADES. CONTRACTOR TO COORDINATE WITH RESPECTIVE UTILITY COMPANIES FOR GAS/TELECOMM/ABLE/ELECTRIC.
- ALL VERTICAL GRANITE CURBING WITHIN WORK LIMITS SHALL BE REMOVED AND RESET UNLESS OTHERWISE NOTED. GRANITE CURBING TO BE REINSTALLED TO ORIGINAL GRADE AND FINISH. GRANITE CURBING TO BE REINSTALLED WITH AUTHORIZATION FROM THE RESIDENT ENGINEER OR CITY OF CAMBRIDGE.
- AT LOCATIONS WITH EXISTING TREES TO REMAIN, CONTRACTOR SHALL MAINTAIN 8\"/>

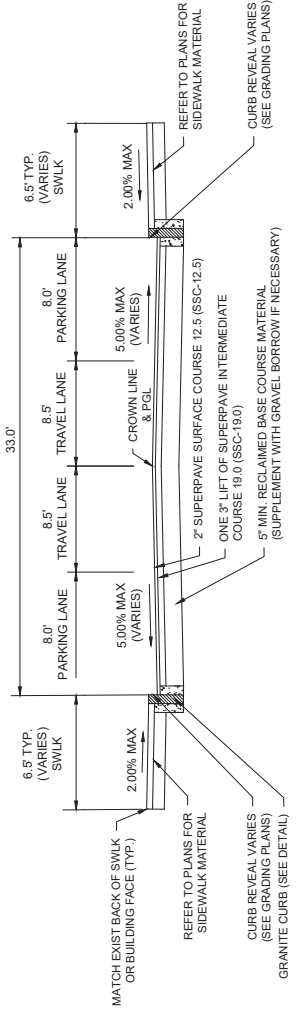

CENTRE STREET
STA. 105+50 TO STA. 107+00
 SCALE: NTS

ISSUED FOR BID

		Client	CITY OF CAMBRIDGE, MASSACHUSETTS
Scale	AS NOTED	Project	CHAPTER 90 CONTRACT 25
Date	JANUARY 2024	Drawing	CENTRE STREET - CONSTRUCTION PLAN
Job No.	2023108.020A		STA 105+50 TO 107+00
Designed by	JPP/FG		
Drawn by	AJZ/GLD		
Checked by	PFB	No.	
Approved by	BMS	Description	REVISIONS
		Date	



Sheet R-2
 File No. 11393